



# Janisol Arte 2.0

New developments and innovations for the  
Janisol Arte system

# Janisol Arte 2.0

## The new generation



### Simplified fabrication; new materials for profiles

The second generation of the Janisol Arte window system now offers profiles made from stainless steel and Corten steel as well as a wide range of profiles. The integrated weatherstrip groove simplifies and speeds up fabrication. A large selection of glazing beads is also available in a variety of different materials.

The wide range of opening types is ideally suited for the renovation of old windows but also for modern residential construction. With the narrowest profile face widths of only 25 or 40 mm for fixed glazing and a basic depth of 60 mm, intricate yet stable constructions with a large proportion of glass and excellent thermal insulation can be created.

#### Design benefits

- Inward and outward-opening fixed glazing/window vents
- Single and double-vent windows
- Inward-opening side-hung, bottom-hung and double-vent windows
- Outward-opening side-hung, top-hung, double-vent, horizontal pivot and projected top-hung windows
- Vent sizes of 1000 × 2400 mm
- Vent weight of up to 150 kg
- Unit thicknesses from 20 to 47 mm
- $U_w$  value from 0.8 W/m<sup>2</sup>K
- Multi-point window locking
- New materials for profiles: stainless steel and Corten

#### Fabrication benefits

- Composite technology tested in accordance with EN 14024
- CE classification in accordance with EN 14351-1
- Optimum weldability of the profile frame due to the ZF surface finish
- Mechanical strength tested in accordance with EN 13115
- Impact resistance tested in accordance with EN 13049



Janisol Arte 2.0



Janisol Arte 2.0 stainless steel



Janisol Arte 2.0 Corten



### Janisol Arte horizontal pivot window

The new Janisol Arte horizontal pivot window has been successfully CE marked. Vents of up to 1400 × 1600 mm can be constructed as manual or motorised versions.

- Vent weights of up to 100 kg
- Watertightness 8A - 450 Pa
- Air permeability up to class 4
- Sound reduction up to 40 dB

### Janisol Arte sliding doors

With the extremely slimline steel profile system Janisol Arte, large sliding doors can be created with narrow face widths and a high degree of stability. Originally developed by Jansen for the reconstruction of historic windows, Janisol Arte now offers architects and developers the opportunity to create large glass fronts.

- Unit sizes of up to 3000 × 2500 mm (W×H)
- Max. weight of 150 kg per leaf
- Insulating glass of 20 to 34 mm
- $U_w$  value of 1.5 W/m<sup>2</sup>K
- Welded steel half profiles in combination with glass fibre-reinforced high-performance plastics (100% recyclable) produce particularly stable frames
- Profile face widths of just 40 mm ensure increased light penetration and also increase the energy efficiency of the building
- CE marking in accordance with EN 14351-1
- Profile rolling technology tested in accordance with EN 14024
- Sound reduction of up to 41 dB



## Technical data

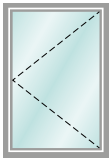

### Single-vent side-hung window inward opening

Max. dimensions:  
970 × 2370 mm (FFB×FFH)  
Min. dimensions:  
370 × 370 mm (FFB×FFH)  
Max. vent weight: 150 kg

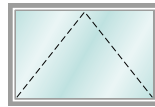

### Bottom-hung window inward opening

Max. dimensions:  
810 × 1620 mm (FFB×FFH)  
or  
1620 × 810 mm (FFB×FFH)  
Min. dimensions:  
370 × 370 mm (FFB×FFH)  
Max. vent weight: 60 kg  
Use weld-on hinges 555.483

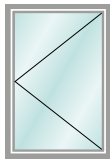

### Single-vent side-hung window outward opening

Max. dimensions:  
970 × 2370 mm (FFB×FFH)  
Min. dimensions:  
470 × 370 mm (FFB×FFH)  
Max. vent weight: 150 kg

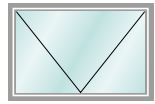

### Top hung window outward opening

Max. dimensions:  
810 × 1610 mm (FFB×FFH)  
or  
1610 × 810 mm (FFB×FFH)  
Min. dimensions:  
370 × 470 mm (FFB×FFH)  
Max. vent weight: 60 kg

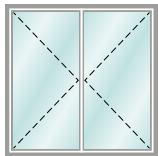

### Double-vent side-hung window inward opening

Max. dimensions:  
1970 × 2370 mm (RFB×FFH)  
Min. dimensions:  
720 × 560 mm (RFB×FFH)  
Access leaf min. FFB 420 mm  
Max. vent weight: 150 kg

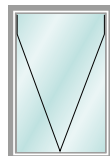

### Projected top-hung window outward opening

Max. dimensions:  
1160 × 1410 mm (FFB×FFH)  
Min. dimensions:  
300 × 300 mm (FFB×FFH)  
Max. vent weight: 60 kg

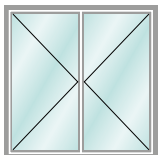

### Double-vent side-hung window outward opening

Max. dimensions:  
1970 × 2370 mm (RFB×FFH)  
Min. dimensions:  
820 × 670 mm (RFB×FFH)  
Access leaf min. FFB 520 mm  
Max. vent weight: 150 kg

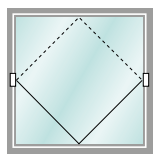

### Horizontal pivot window inward and outward opening

Max. dimensions:  
1370 × 1570 mm (FFB×FFH)  
Max. surface 1.1881 m<sup>2</sup>  
Min. dimensions:  
Manual: 370 × 570 mm (FFB×FFH)  
Electric: 470/670 × 370 mm (FFB×FFH)  
Max. vent weight: 100 kg

FFB = Vent rebate width  
FFH = Vent rebate height  
RFB = Frame rebate width

Janisol Arte 2.0 profile range

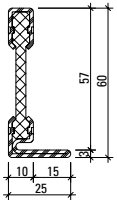

601.611 Z  
601.611.01  
601.611.09

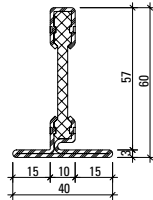

602.611 Z  
602.611.01  
602.611.09

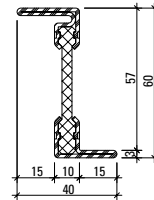

603.611 Z  
603.611.01  
603.611.09

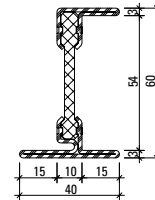

605.611 Z  
605.611.01  
605.611.09

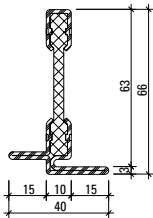

602.612 Z  
602.612.01  
602.612.09

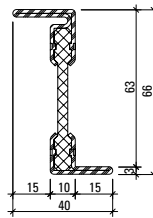

603.612 Z  
603.612.01  
603.612.09

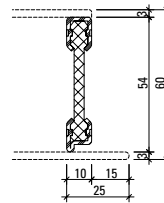

600.609 Z

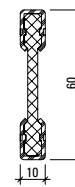

600.610 Z

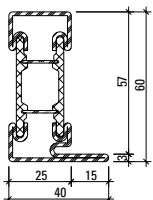

601.615 Z

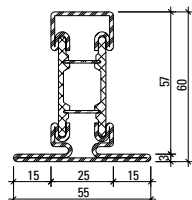

602.615 Z  
602.615.01

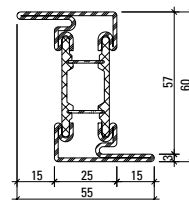

603.615 Z

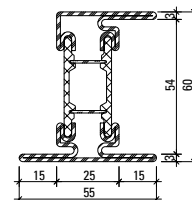

605.615 Z

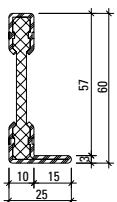

601.610  
601.610 Z  
601.610.01  
601.610.09

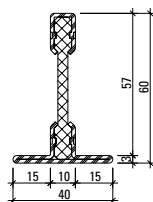

602.610  
602.610 Z  
602.610.01  
602.610.09

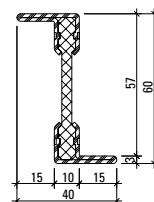

603.610  
603.610 Z  
603.610.01  
603.610.09

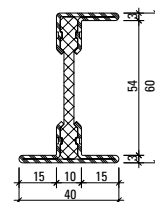

605.610  
605.610 Z  
605.610.01  
605.610.09

**Part no.**

without addition = bright

with Z = hot-dip galvanised steel

with 01 = Stainless steel, bright, material 1.4401 (AISI 316)

with 09 = Steel KB DOCOL 355W (Corten)



Choice of glazing bead for Janisol Arte 2.0 in steel, aluminium, stainless steel and Corten

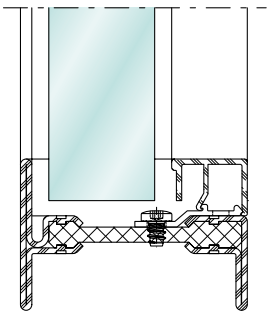

Aluminium

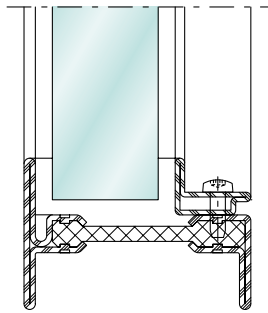

Steel

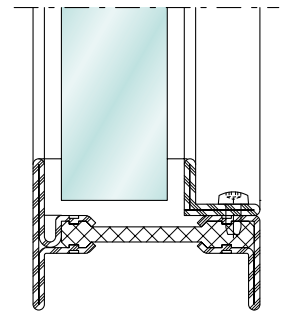

Steel  
Stainless steel  
Corten

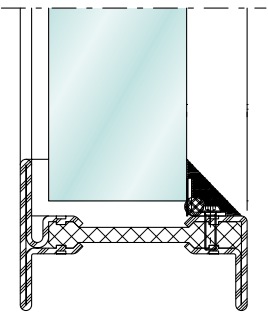

Renseal

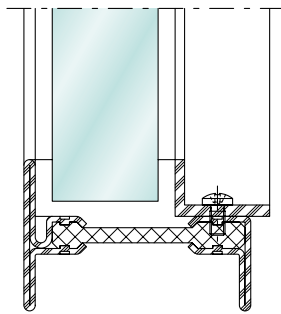

Steel  
Stainless steel

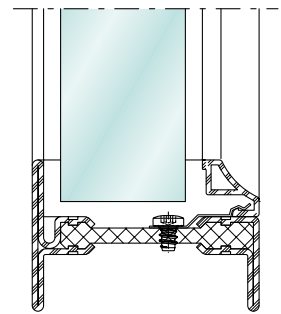

Aluminium

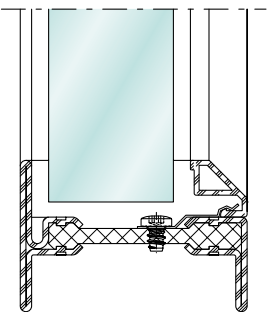

Aluminium

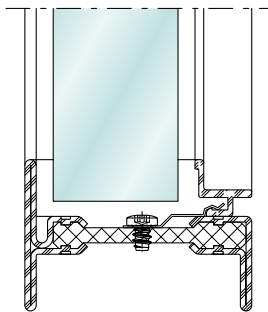

Aluminium

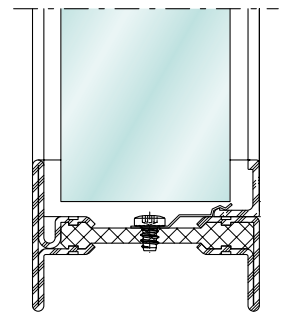

Aluminium

Example of Janisol Arte 2.0

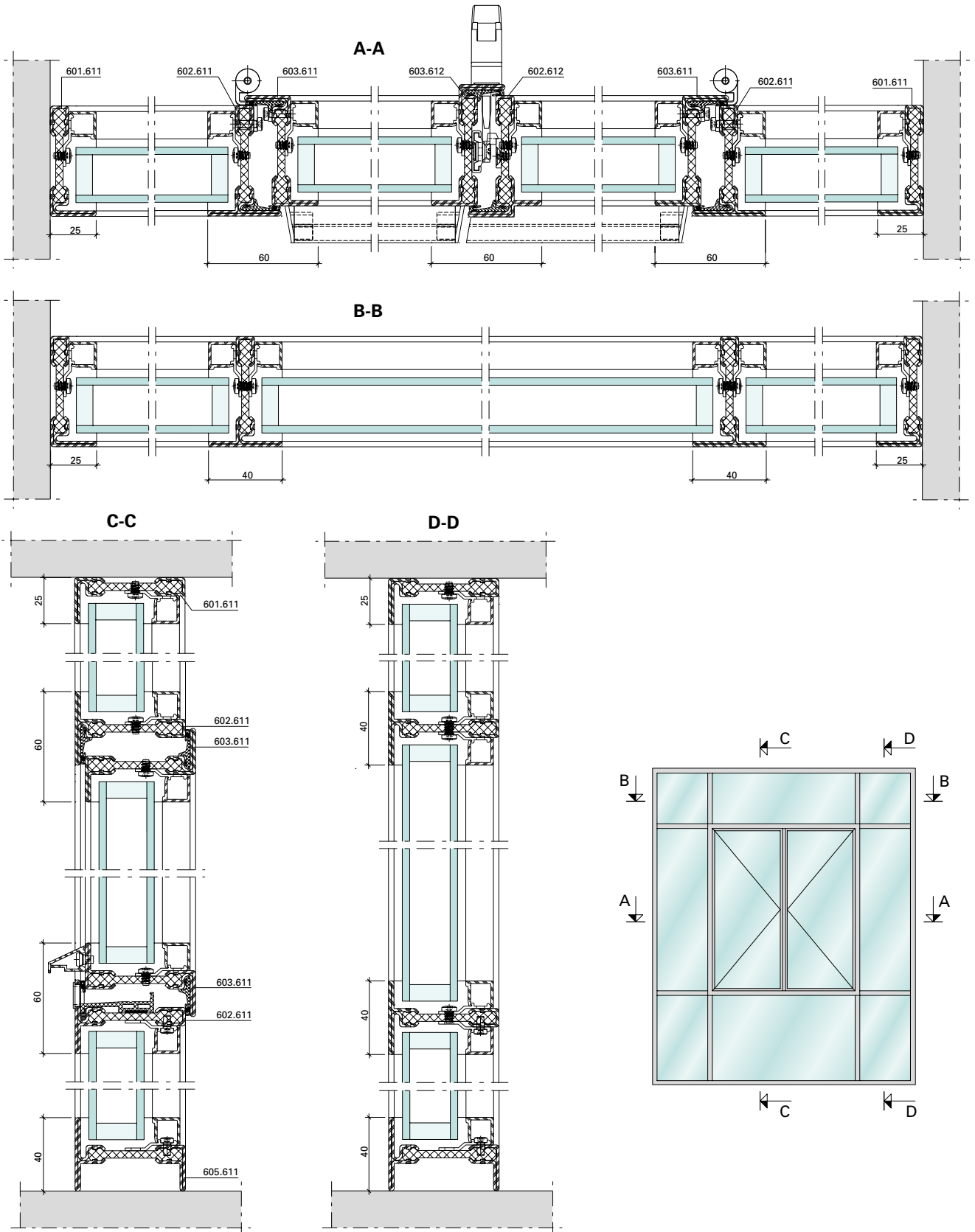

Jansen AG

**Steel Systems**  
Industriestrasse 34  
9463 Oberriet  
Schweiz  
[jansen.com](http://jansen.com)

**JANSEN**  
Configure to Inspire