



Fire protection

Smoke and fire doors and glazing

Functional fire protection in its most beautiful form

Steel is neither flammable, nor does it suffer any significant loss of its inherent stability in the event of a fire. For this reason, it is predestined for use as a material in the fabrication of fire doors and glazing.

Fire doors made from steel can help to save lives in cases of emergency. Whether in private, commercial or public buildings - fire doors are used to separate fire compartments and significantly delay the spread of smoke and fire. Thanks to their insulating properties, they counteract an increase in temperature on the side facing away from the fire, which helps to secure the escape routes in stairwells or corridors, for example.

Numerous approvals in different countries attest to the quality of the Jansen products, which cover a variety of fire resistance classes and therefore a wide range of applications.

The approvals are continually improved and extended as a result of an active exchange with users and building authorities.

The tried-and-tested fire and smoke protection systems from Jansen combine functionality, flexibility and aesthetics. With these profile systems, narrow profile face widths are also possible for high security requirements.

The option to combine the different fire doors and glazing types provides the basis for holistic and economical system solutions whilst also meeting protection objectives.





Jansen-Economy E30 Fire doors

Jansen-Economy 50 E30

E30 smoke/fire doors and closures made from steel and stainless steel successfully prevent the spread of flames and smoke in the event of a fire. Jansen-Economy 50 E30 allows transparent building components to be manufactured economically. The basic depth for door frames and leaves is only 50 mm. Flush-fitted doors with a continuous shadow joint inside and outside can be fabricated with this profile system. In the event of fire, a low flammability double rebate gasket guarantees a secure barrier.

Jansen-Economy 60 E30

The profile system with a basic depth of 60 mm is especially suitable for all applications which require large E30 smoke/fire closures with a slimline look. The robust and extremely torsion-proof Jansen-Economy 60 E30 steel profiles allow the production of solid single and double-leaf door systems. The tailored range of fittings includes locks, strike plates, electric strikes, door handles and specially developed 3D-adjustable weld-on or screw-on hinges. The appearance is coordinated to match the other Jansen door systems. In this way, different requirements can be met with a single uniform appearance.



Example of Jansen-Economy 50 E30 doors

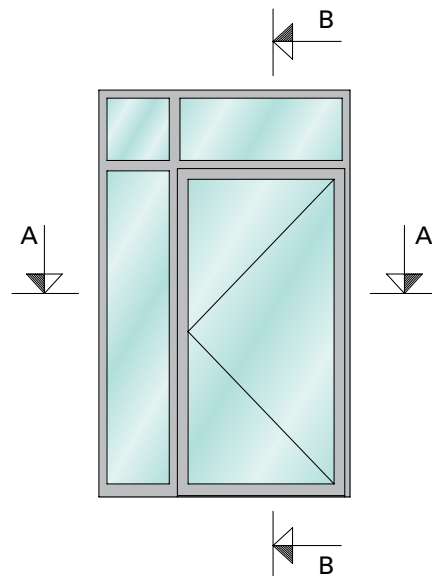
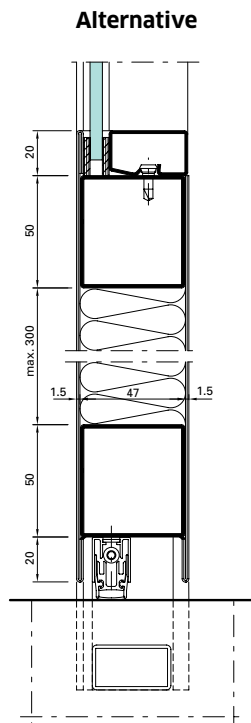
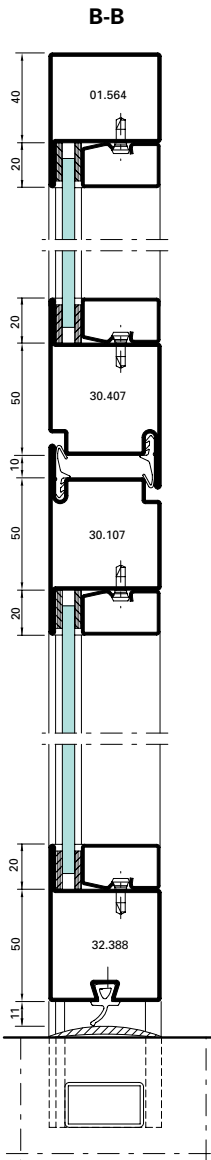
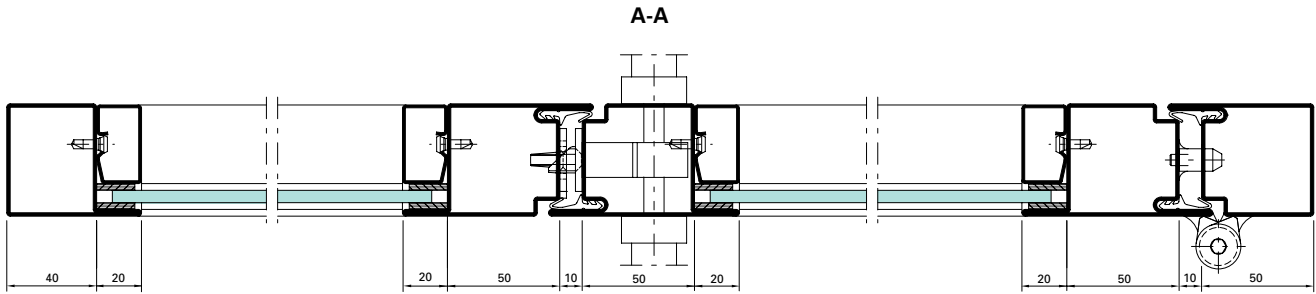

Example of Jansen-Economy 60 E30 doors

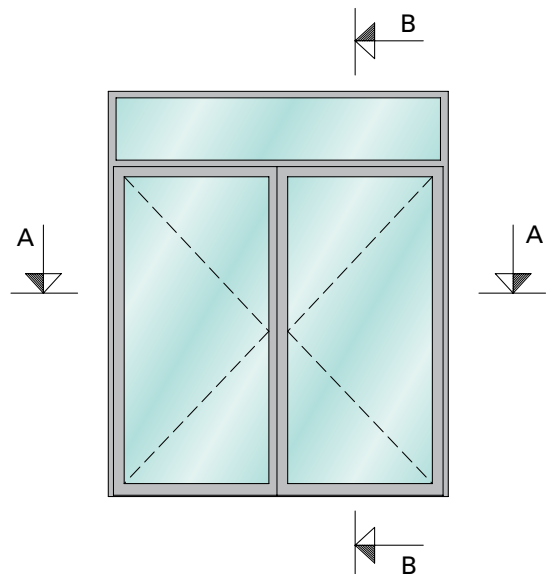
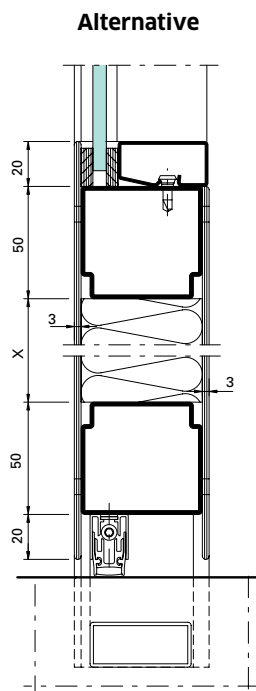
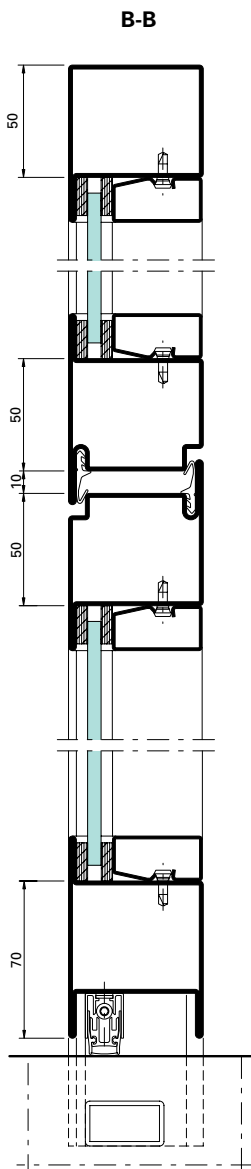
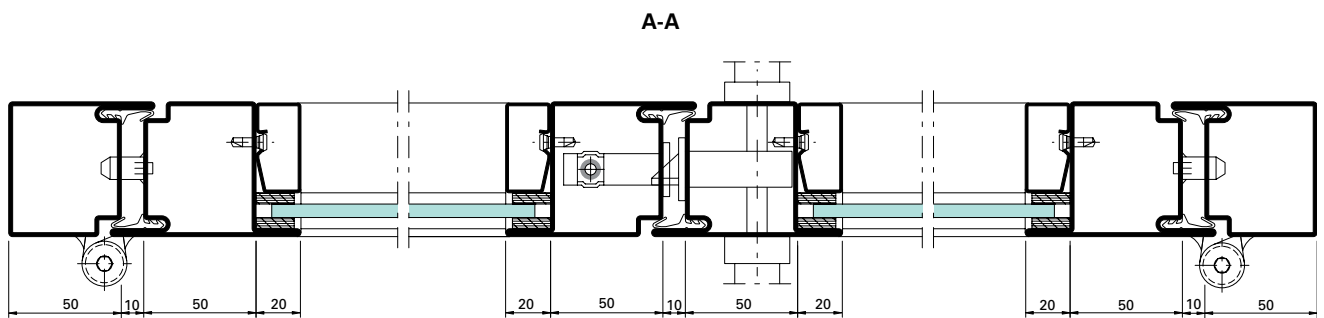



Jansen-Economy RS

Smoke doors

Jansen-Economy 50 RS

The Jansen-Economy 50 RS system, which is made from steel and stainless steel, offers clear benefits in terms of security and cost. The simple geometry of the profiles with a basic depth of 50 mm allows efficient fabrication of flush-fitted, single and double-leaf smoke doors in accordance with DIN 18095 and EN 1634-3.

A comprehensive range of tested, system-specific fittings and door handles in aluminium or stainless steel ensures that the units are fabricated to the correct standards. Locks and fittings can be integrated easily into the hollow profile section.

Jansen-Economy 50 RS is virtually identical in appearance to EI30 fire protection barriers from the Janisol 2 system.

Jansen-Economy 60 RS

A complete profile system for single and double-leaf door systems in accordance with DIN 18095 and EN 1634-3 that also enables large units with the familiar narrow face widths and includes a comprehensive range of system-specific and approved locks and fittings. The door closer integrated into the profile offers an attractive solution. As it can also be created cost-effectively with the Jansen-Economy 60 profile system, it is an attractive feature even for larger building components.

Jansen-Economy 60 RS is also approved as a burglar-resistant door in accordance with DIN EN 1627 and corresponds to resistance class RC3.



Example of Jansen-Economy 50 RS doors

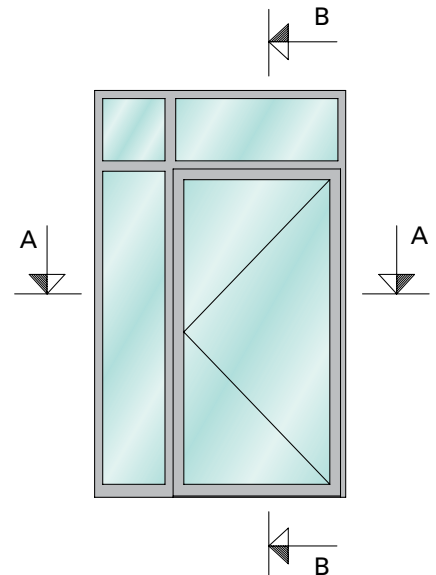
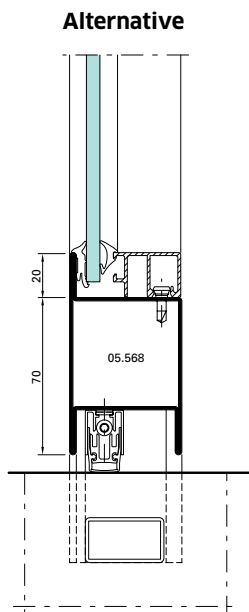
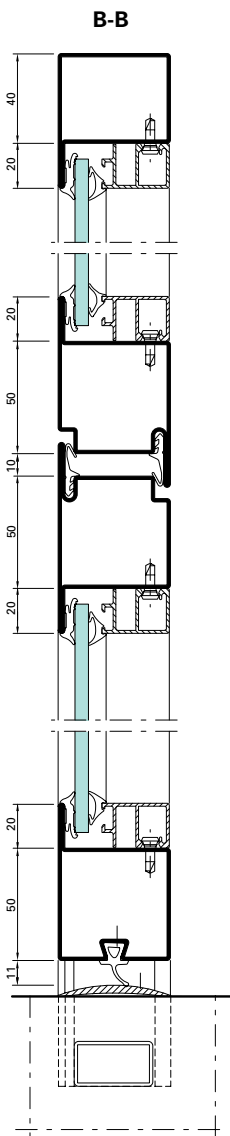
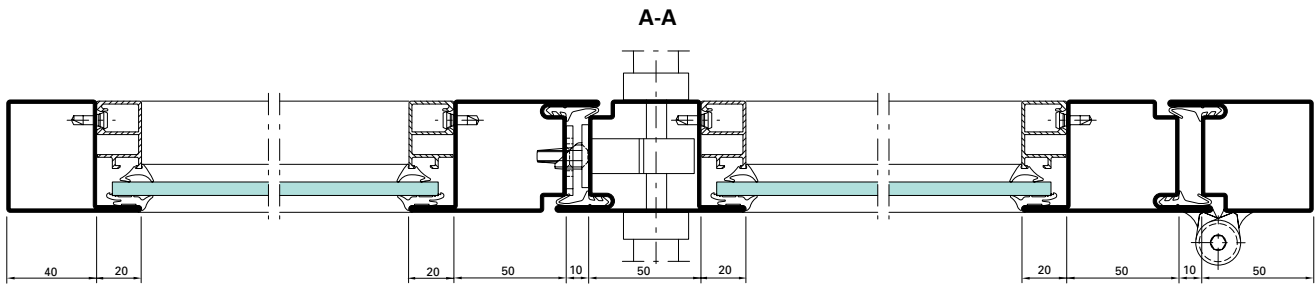

Example of Jansen-Economy 60 RS doors

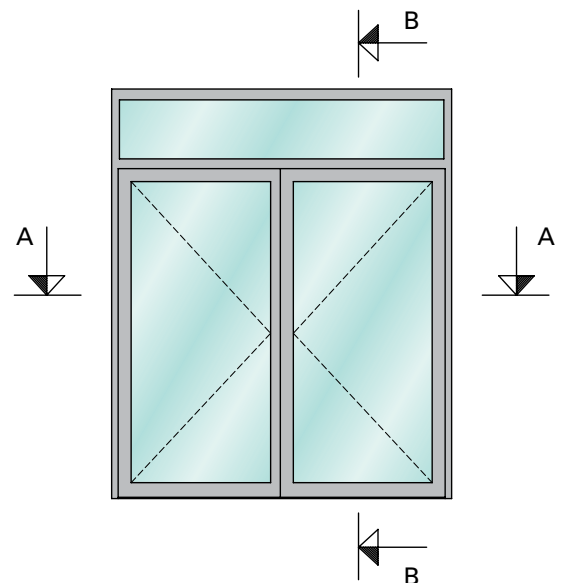
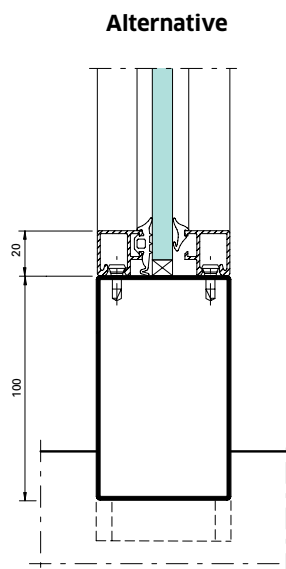
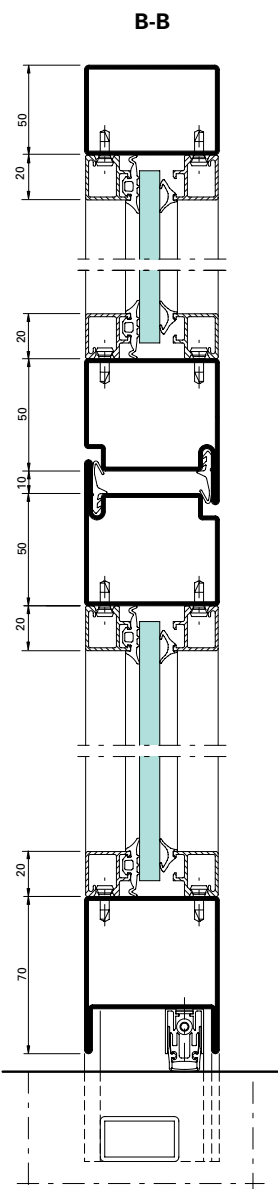
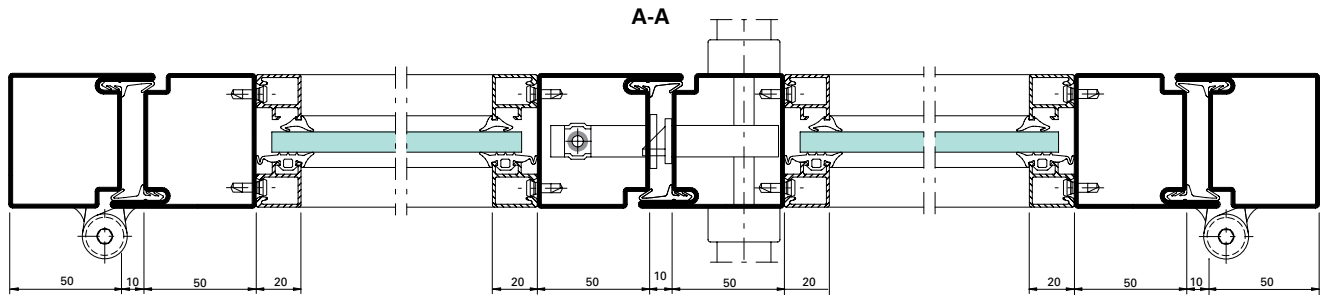

Profile range

Jansen-Economy 50

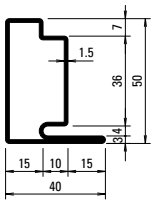

30.006
30.006 Z
30.006.01
30.006.03
30.006.05
30.006.07

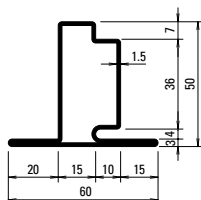

30.106
30.106 Z
30.106.01
30.106.03
30.106.05
30.106.07

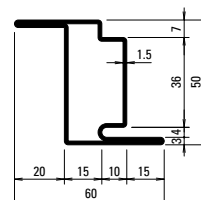

30.406
30.406 Z
30.406.01
30.406.03
30.406.05
30.406.07

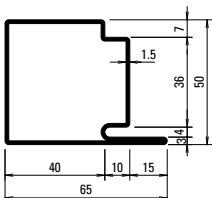

30.007
30.007 Z
30.007.01
30.007.03
30.007.05
30.007.07

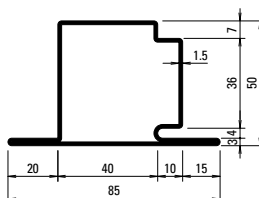

30.107
30.107 Z
30.107.01
30.107.03
30.107.05
30.107.07

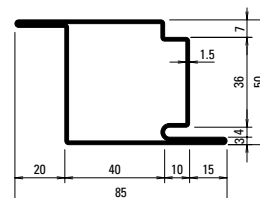

30.407
30.407 Z
30.407.01
30.407.03
30.407.05
30.407.07

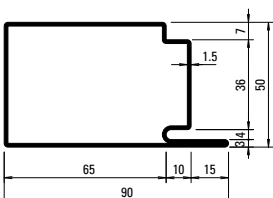

30.008
30.008 Z

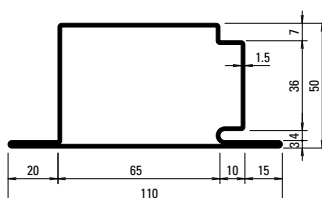

30.108
30.108 Z

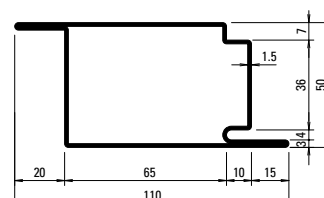

30.408
30.408 Z

Z = made from hot-dip galvanised strip

01 = Stainless steel, bright material 1.4404 (AISI 316L)

05 = Stainless steel, bright material 1.4307 (AISI 304L)

03 = Stainless steel polished, grain 220-240 material 1.4404 (AISI 316L)

07 = Stainless steel polished, grain 220-240 material 1.4307 (AISI 304L)

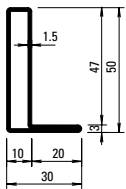

01.531
01.531 Z

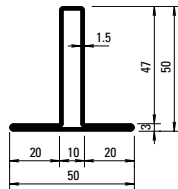

02.531
02.531 Z

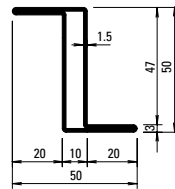

03.531
03.531 GV+GC

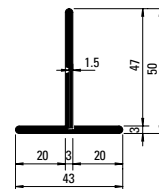

400.023
400.023 Z

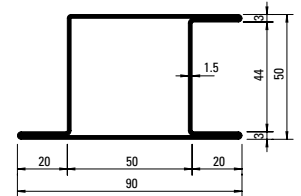

05.568
05.568 Z
[05.568.01](#)
[05.568.03](#)
[05.568.05](#)
[05.568.07](#)

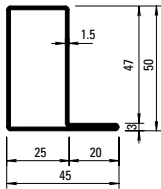

01.534
01.534 Z
[01.534.01](#)
[01.534.03](#)
[01.534.05](#)
[01.534.07](#)

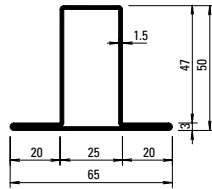

02.534
02.534 Z
[02.534.01](#)
[02.534.03](#)
[02.534.05](#)
[02.534.07](#)

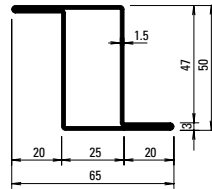

03.534
03.534 Z
[03.534.01](#)
[03.534.03](#)
[03.534.05](#)
[03.534.07](#)

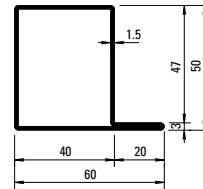

01.564
01.564 Z
[01.564.01](#)
[01.564.03](#)
[01.564.05](#)
[01.564.07](#)

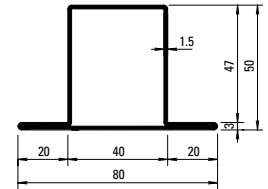

02.564
02.564 Z
[02.564.01](#)
[02.564.03](#)
[02.564.05](#)
[02.564.07](#)

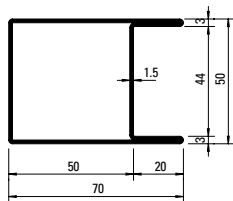

04.568
04.568 Z

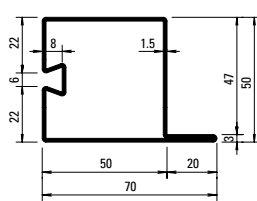

32.388
32.388 Z

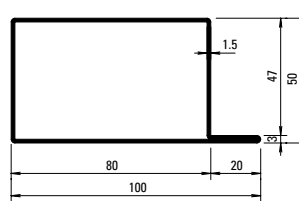

01.592
01.592 Z

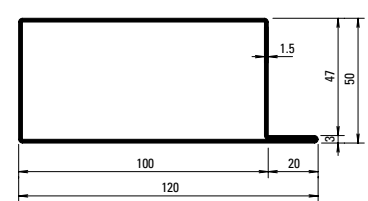

01.596
01.596 Z

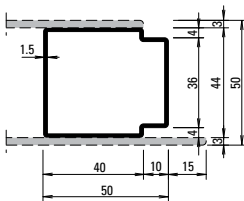

81.009
81.009 GV+GC

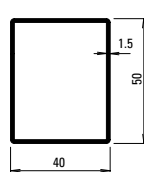

400.048
400.048 GV+GC

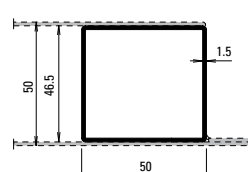

400.049
400.049 GV+GC

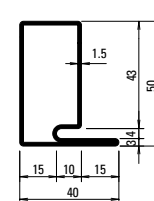

30.021
30.021 GV+GC

GV+GC = outside galvanised and
yellow chromated

Profile range Jansen-Economy 60

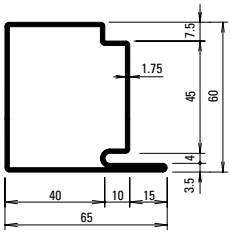

30.019
30.019 Z

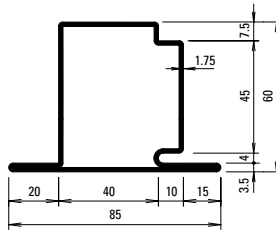

30.119
30.119 Z

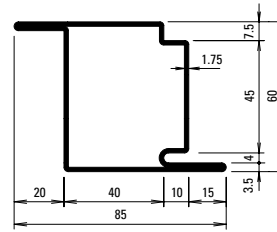

30.419
30.419 Z

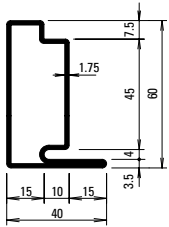

30.018
30.018 Z

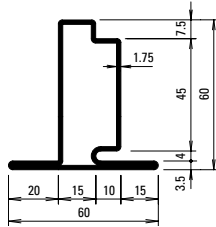

30.118
30.118 Z

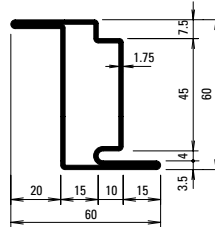

30.418
30.418 Z

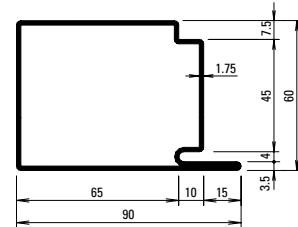

30.017
30.017 Z

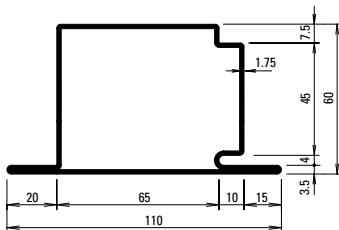

30.117
30.117 GV+GC

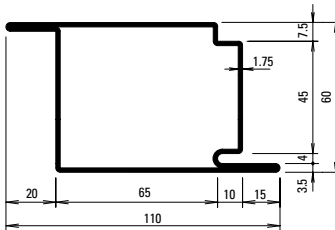

30.415
30.415 GV+GC

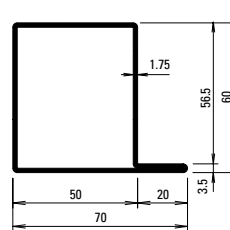

01.684
01.684 Z

Z = made from hot-dip galvanised strip

GV+GC = outside galvanised and yellow chromated

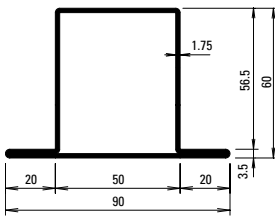

02.684
02.684 Z

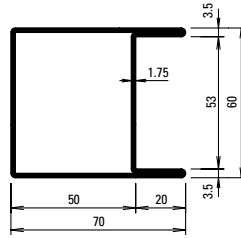

04.637
04.637 Z

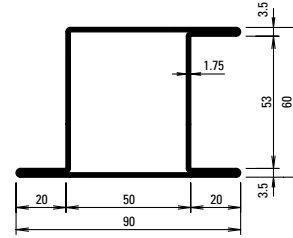

05.637
05.637 Z

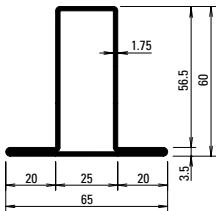

02.634
02.634 Z

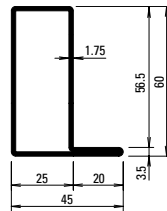

01.634
01.634 Z

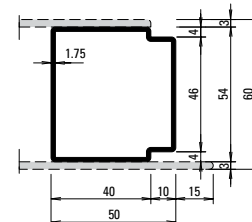

81.010
81.010 GV+GC

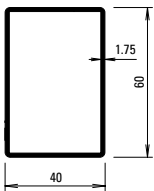

400.052
400.052 GV+GC

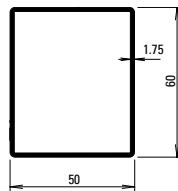

400.054
400.054 GV+GC

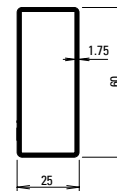

400.055
400.055 GV+GC

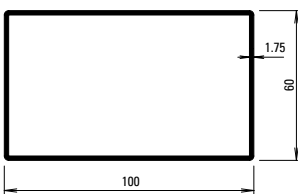

400.051
400.051 GV+GC

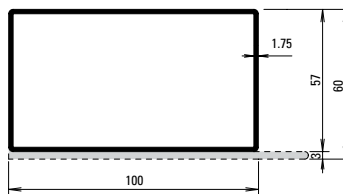

400.050
400.050 GV+GC

Janisol 2 EI30

Fire doors

Secure fire containment

The thermally broken Janisol 2 EI30 profile system enables the efficient and reliable fabrication of single and double-leaf doors, fire-resistant glazing and doors in glass walls. The basic depth for door frames and door leaves is just 60 mm.

Profiles with face widths of 25, 50 and 85 mm can be used for mullions and transoms. A continuous shadow joint inside and outside lends the construction a certain lightness and elegance with

extremely narrow profile face widths. Fire-resistant glazing from a variety of providers can be used for infill units. A comprehensive range of fully tested fittings, locks, accessories and integrated door closers is also available. These can be integrated very easily into the hollow profile section. The appearance is coordinated to match that of all the other Jansen door systems. Janisol 2 EI30 has many approval certificates. These are constantly being

extended and improved in consultation with users and the building authorities. The many successfully tested system variations allow particularly cost-efficient, attractive and complex project solutions in line with objectives. Janisol 2 EI30 doors have also been tested as burglar-resistant doors in accordance with EN 1627, classified in resistance class RC3 and are approved as smoke doors in accordance with DIN 18095 and EN 1634-3.



Sheet metal clad fire doors for high design standards

Janisol 2 EI30 sheet metal clad fire doors can be fabricated as single and double-leaf doors with or without glazed sections. The door leaf and outer frame profiles are flush-fitted and therefore lend the construction an elegant appearance. The system provides plenty of scope for creativity whether it is with glazed side sections or toplights.

Janisol 2 sheet metal clad fire doors are characterised not only by their appearance, but also by their simple and efficient fabrication. Smooth sheets can be welded or bonded, removing the need for complicated folding of the sheet metal. In addition, all Janisol 2 fittings can be used; vertical joint and horizontal safety bars are easy to attach.



Our technical consultancy service would be happy to help you with requirements for individual projects or specific countries.





LAUTSPRECHER
LOUDSPEAKER

Example of Janisol 2 EI30

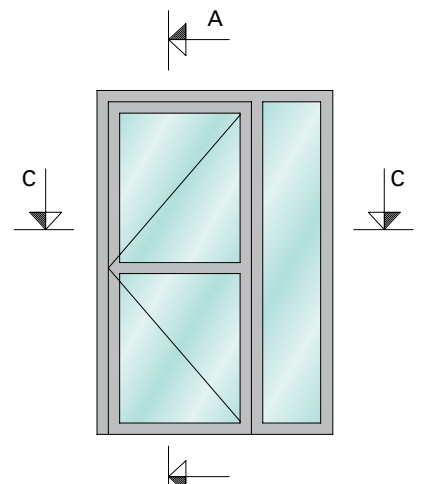
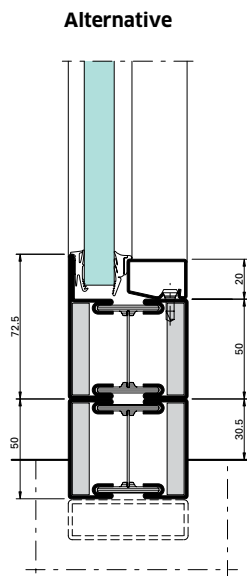
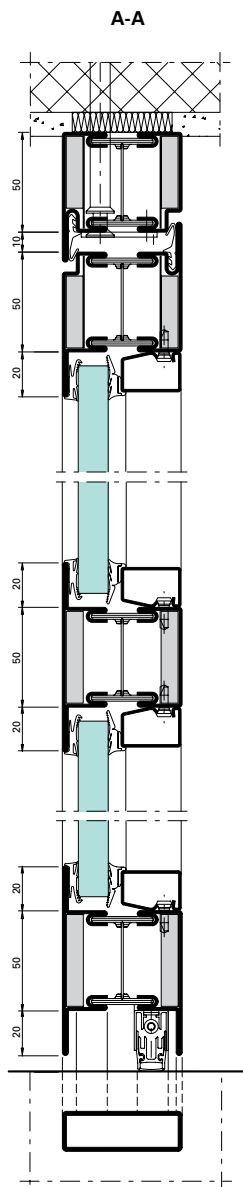
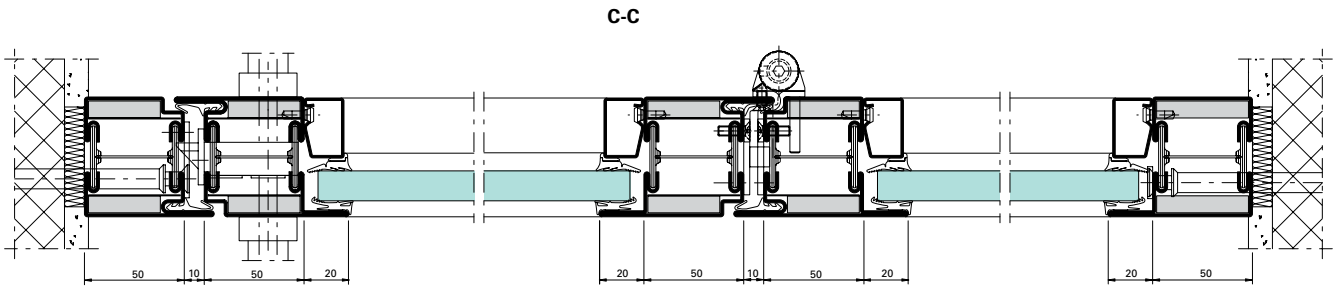

Janisol 2 EI30

Fire-resistant sliding doors

Extremely narrow profile with maximum safety features

The Janisol 2 EI30 fire-resistant sliding door is used in busy buildings requiring easy access, such as shopping centres, stadia or office buildings. The automatic door system has been successfully tested to fire-resistance class EI30 in accordance with EN 1634 with and without integrated emergency exit function, as well as with a wide variety of motors, glass inserts and panels. The maximum clear opening dimensions are 1400 × 2500 mm for single-leaf constructions, and 2800 × 2500 mm for

double-leaf constructions. Door leaf and door frame profiles with a face width of 25 or 50 mm are currently the slimmest fire-resistant steel profiles on the market. A key benefit is simple and reliable fabrication. Thanks to the new special profile filled with ceramic compound for the outer and vent frames, no complex work is necessary for the sheet edge, and no additional fire-resistant panels are required. There is also no need for a floor guide in the entrance area.



Unit overview

Janisol 2 EI30 fire-resistant sliding doors (selection)

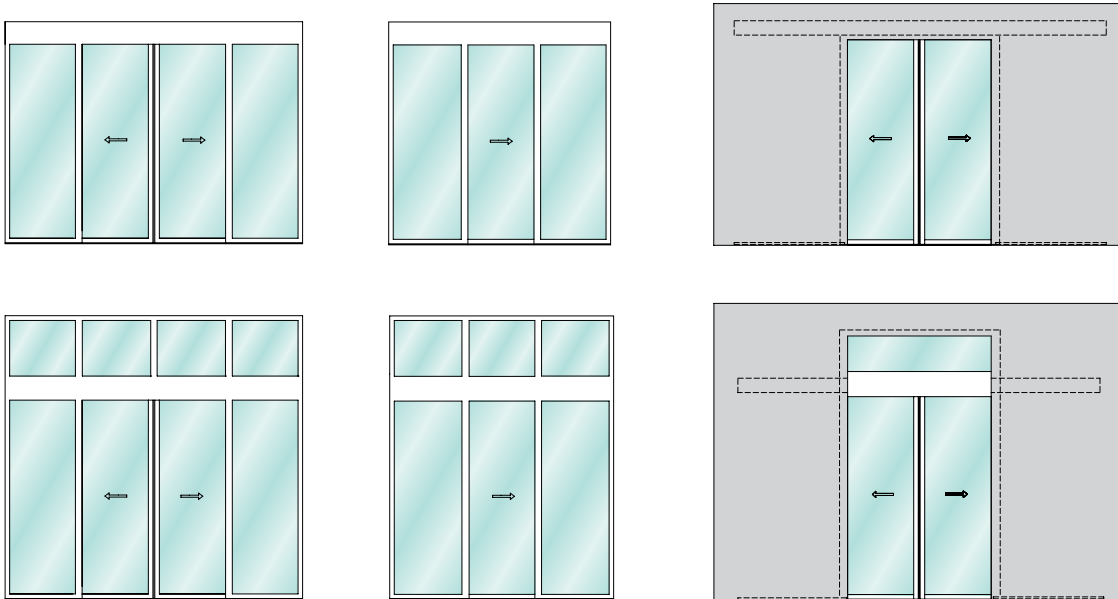

Janisol 2 EI30 fire-resistant sliding doors with "Break-Out" emergency exit function (selection)

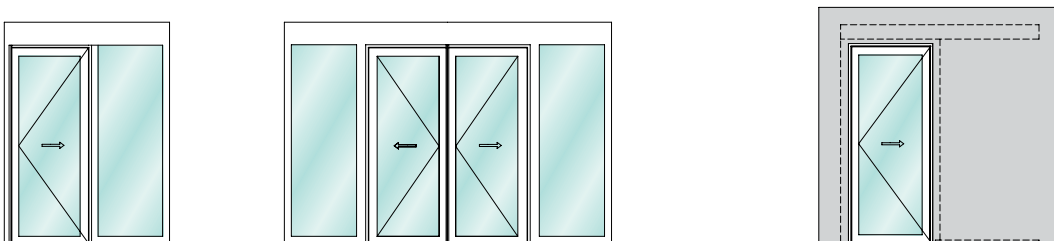

Janisol 2 EI30 fire-resistant sliding doors with "Break-In" emergency exit function (selection)

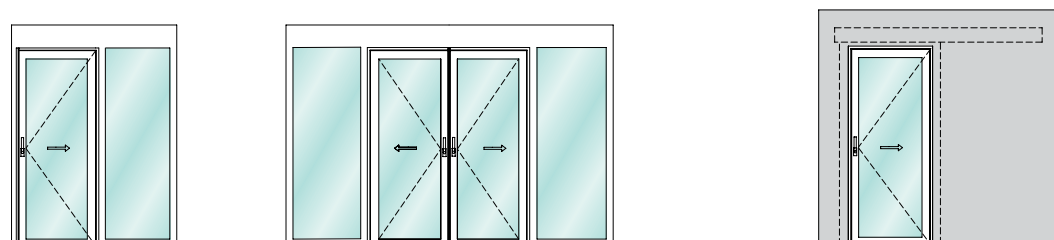

Example of Janisol 2 EI30 fire-resistant sliding door without emergency exit function

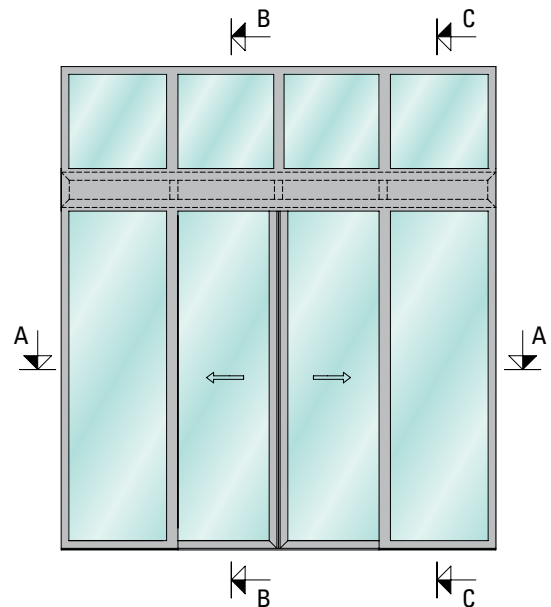
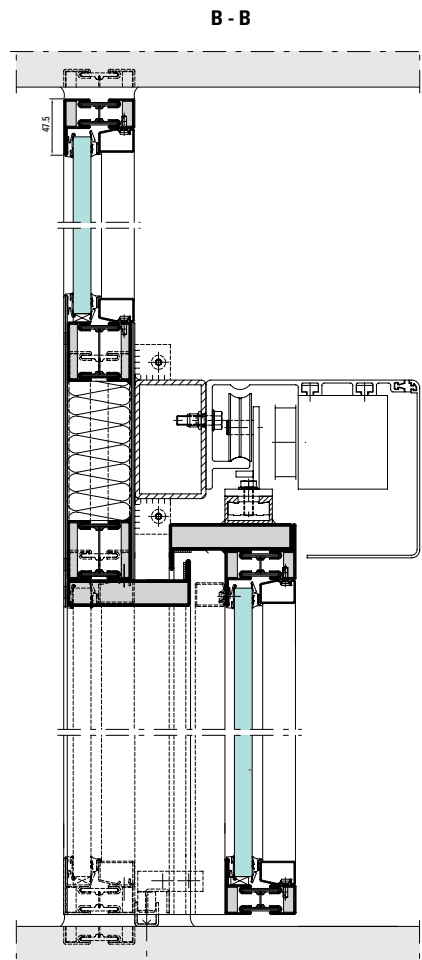
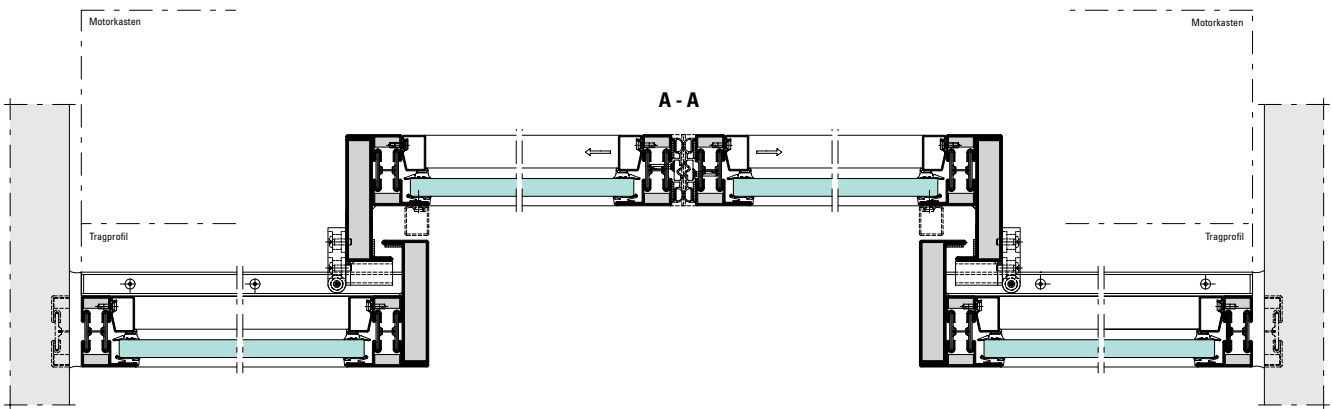

Example of Janisol 2 EI30 fire-resistant sliding door with break-out emergency exit function

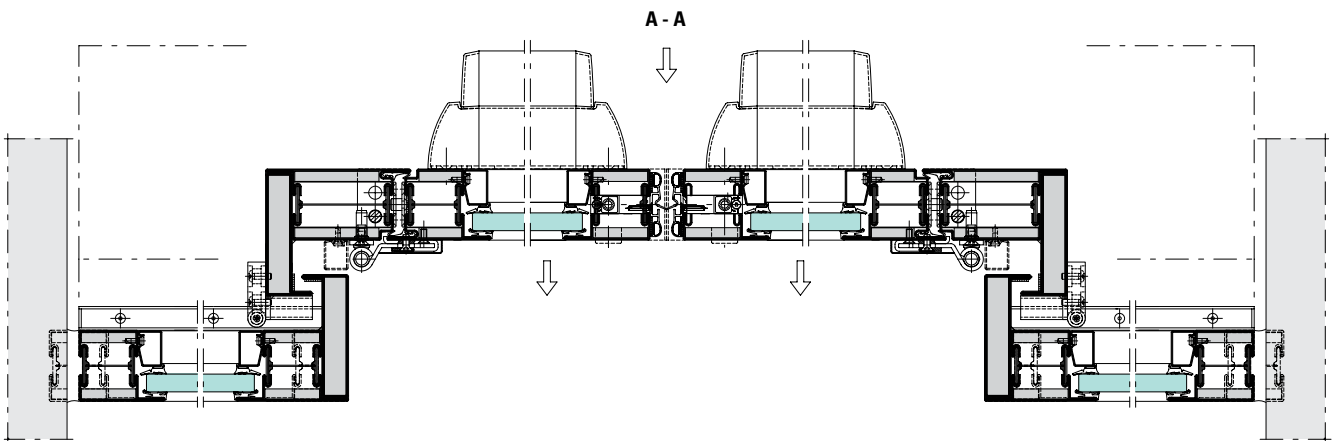

Version with "break-in" emergency exit function

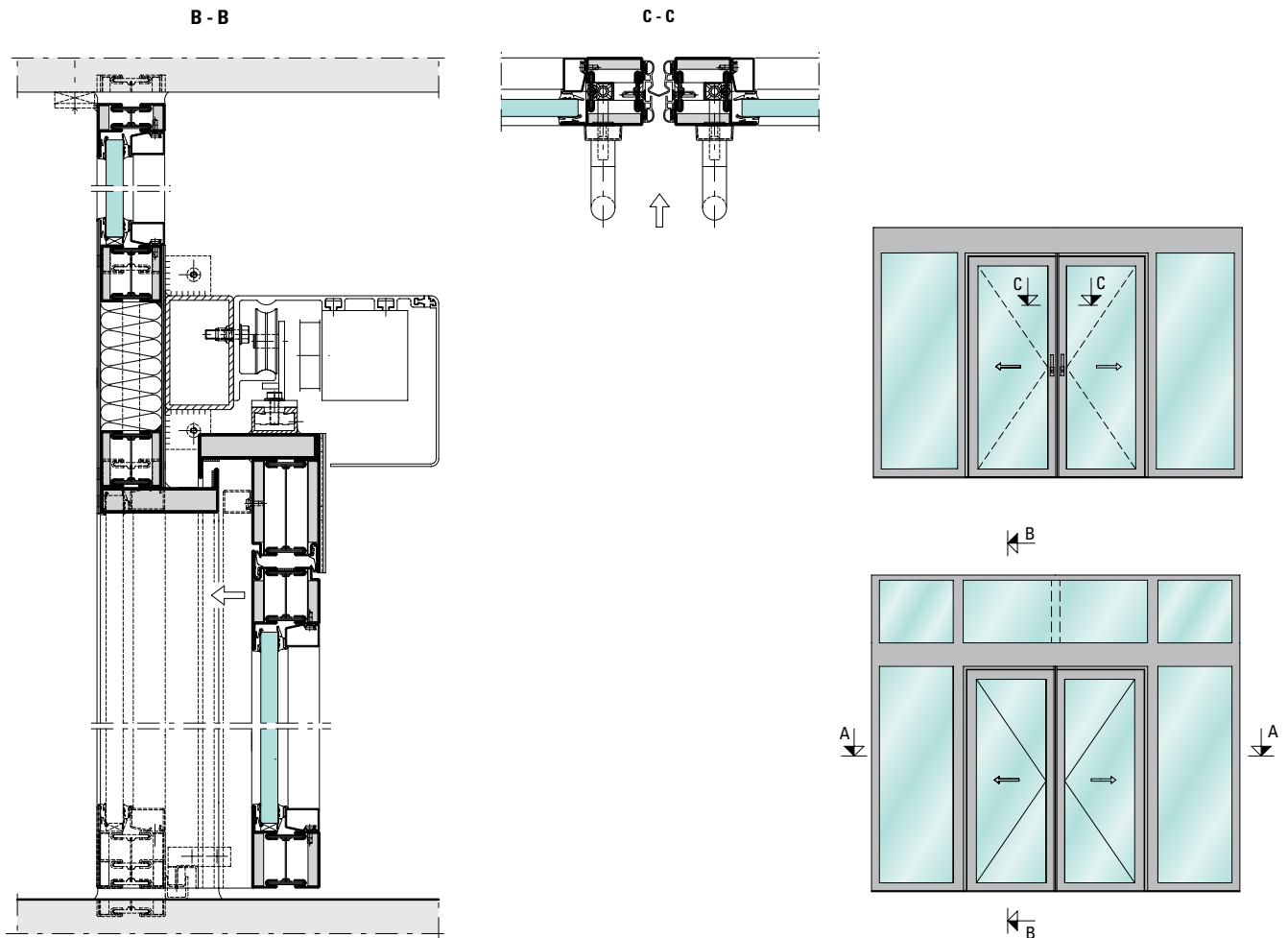

Profile range Janisol 2 EI30

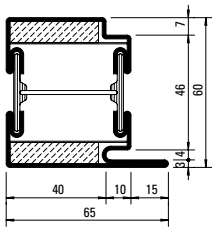

630.013.2
630.013.2 Z
[630.013.21](#)

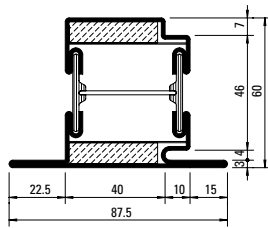

630.114.2
630.114.2 Z
[630.114.21](#)

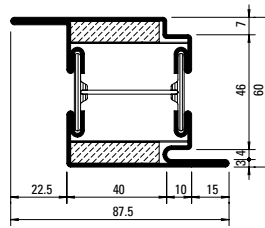

630.416.2
630.416.2 Z
[630.416.21](#)

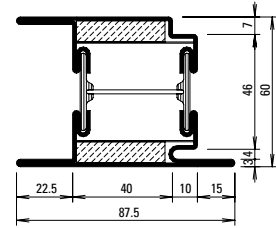

630.428.2
630.428.2 Z

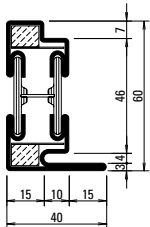

630.010.2 Z

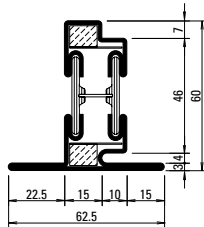

630.110.2 Z

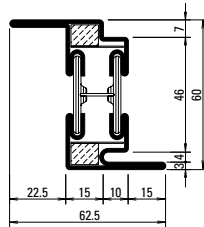

630.411.2 Z

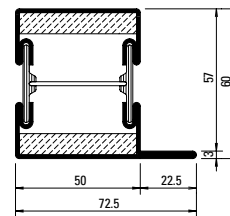

601.685.2
601.685.2 Z
[601.685.21](#)

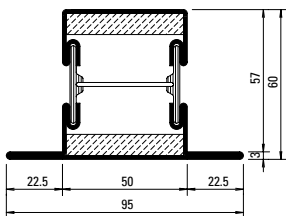

602.685.2
602.685.2 Z
[602.685.21](#)

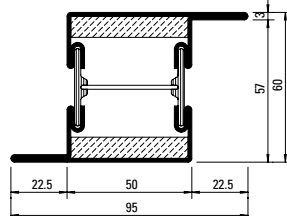

603.685.2
603.685.2 Z
[603.685.21](#)

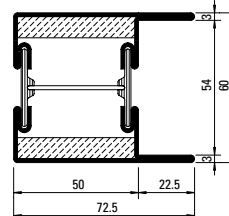

604.685.2
604.685.2 Z
[604.685.21](#)

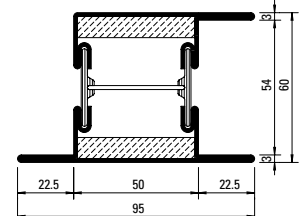

605.685.2
605.685.2 Z
[605.685.21](#)

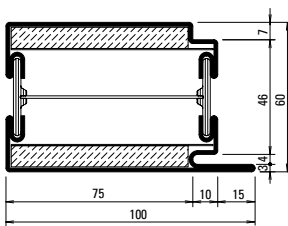

630.016.2
630.016.2 Z

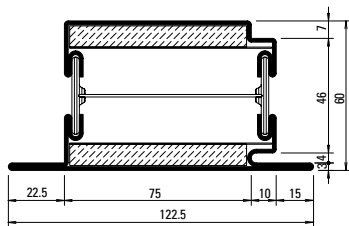

630.115.2
630.115.2 Z

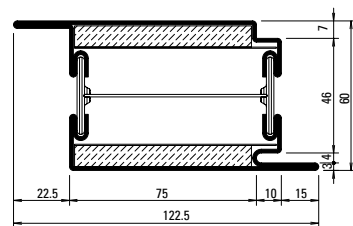

630.417.2
630.417.2 Z

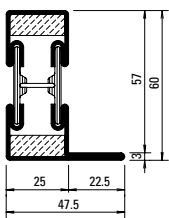

601.635.2
601.635.2 Z

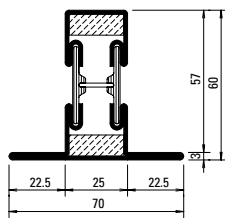

602.635.2
602.635.2 Z

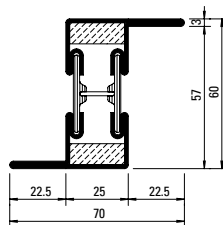

603.635.2
603.635.2 Z

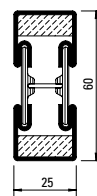

600.006.2
600.006.2 Z

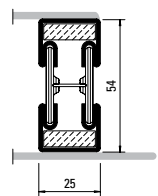

600.008.2 Z

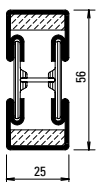

600.002.2
600.002.2 Z

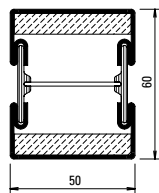

600.005.2
600.005.2 Z
600.005.21

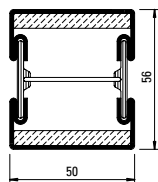

600.001.2
600.001.2 Z

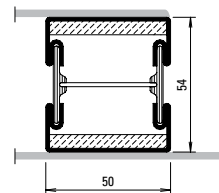

600.007.2 Z

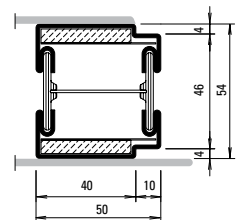

600.010.2 Z

Z = made from hot-dip galvanised strip

21 = Stainless steel, bright, material 1.4401 (AISI 316)

Janisol C4 EI60/EI30 Fire doors

Janisol C4 EI60 and Janisol 2 EI30: a new combination of reliable fire protection systems

Increased requirements for security within a building mean that the demand for functional interaction between different fire protection requirements is becoming more and more frequent. Depending on the specific national regulation, this affects, for example, stairwells that serve as an escape route in emergencies. So that technically demanding combinations also fulfil aesthetic requirements, individual door profiles from the tried-and-tested Janisol 2 EI30 fire protection system were enhanced through the addition of a basic depth of 70 mm. As a result, transparent Janisol C4 EI60 fire walls - in extreme cases even EI90 fire walls - can now be combined with Janisol 2 EI30 doors with ease. The extended range of steel profiles includes door, transom and sill rail profiles in raw and galvanised finishes. Take account of national approvals.

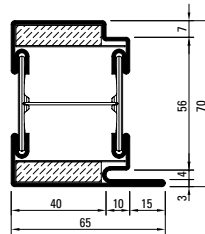

630.013.5
630.013.5 Z

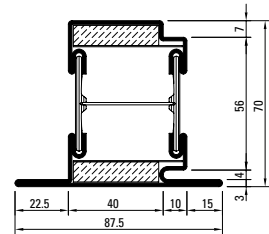

630.114.5
630.114.5 Z

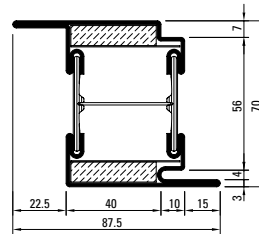

630.416.5
630.416.5 Z

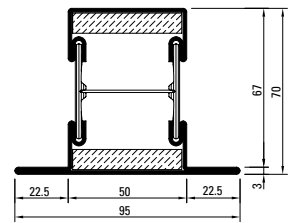

602.685.5
602.685.5 Z

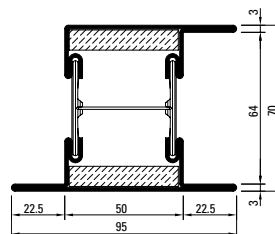

605.685.5
605.685.5 Z

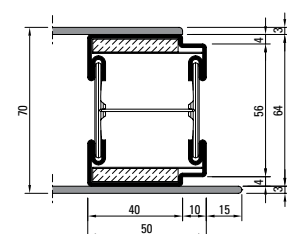

600.010.5 Z

Example of Janisol C4 EI60/EI30 (70 mm)

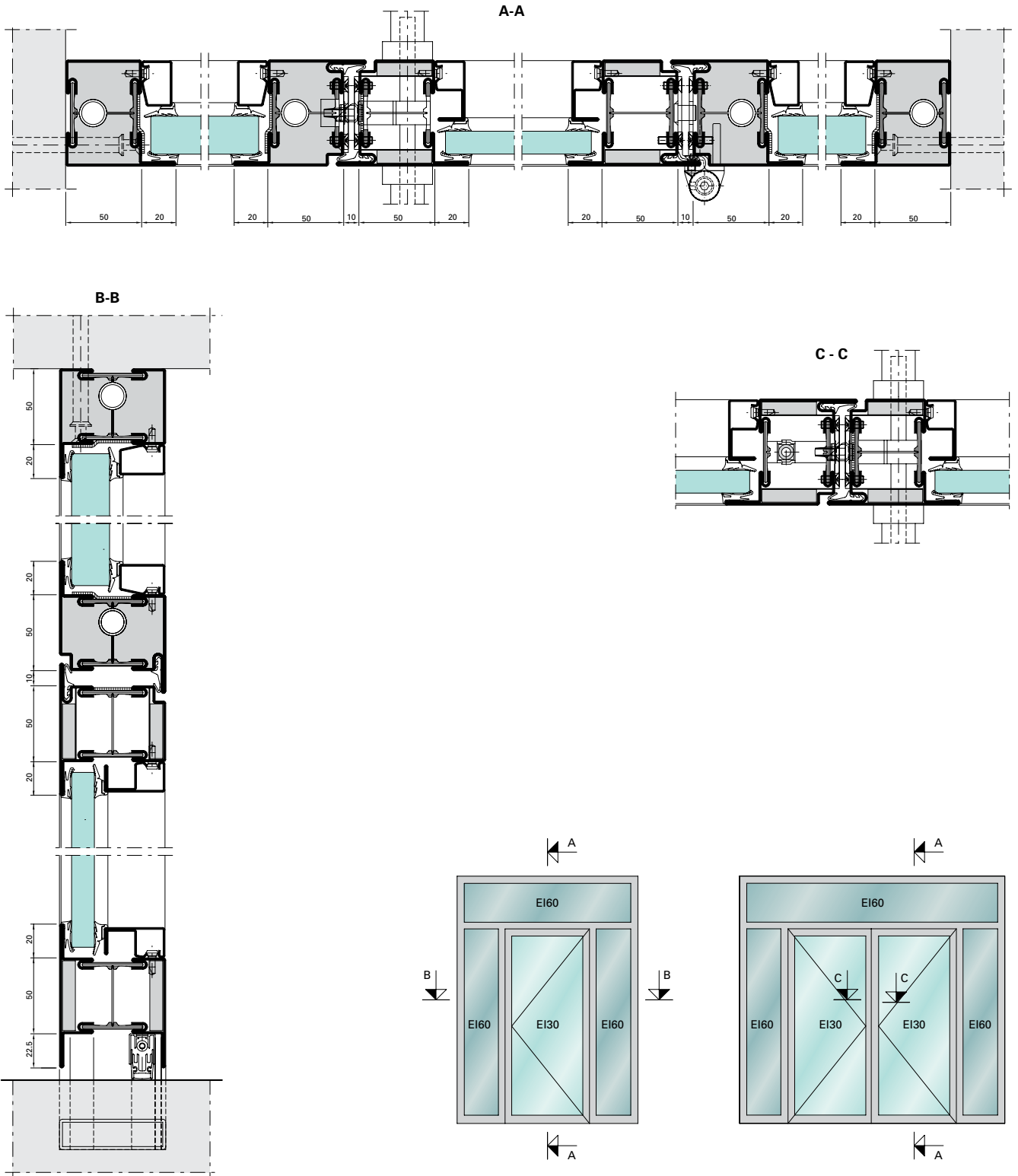



Janisol C4 EI60 and EI90 Fire doors

Maximum fire protection

Janisol C4 is a complete profile system for glazed single- and double-leaf fire doors and glazing. The profiles with a basic depth of just 70 mm achieve security classifications up to EI90 due to the innovative fire-resistant infill panels. The profiles are filled with a ceramic fire board in the factory. This board forms a strong attachment to the steel profile, which is not adversely affected by fabrication steps such as cutting or creating lock recesses. Due to its chemical properties, the ceramic board does not affect the steel surface finish, even on contact with fluids. Consequently, rolled steel profiles can also be filled.

As these constructions are often used for emergency escape routes, an electrical connection to monitoring devices and alarm systems is often required. Janisol C4 profiles are therefore supplied with a cable duct as standard, which allows very simple and secure electrical connections. It can be retrofitted, if required.

The appearance of the Janisol C4 fire-resistant construction is identical to the other Jansen fire protection barriers and the thermally insulated Janisol systems.

Janisol C4 permits the use of particularly narrow outer frame profiles. The fabricator has recourse to a wide selection of various glass thicknesses and panels. Centre glazing is also possible. The profile range, fittings, accessories and fabrication aids are identical for EI60 and EI90. The only difference is the choice of glazing. The result is maximum efficiency in planning and storage, as well as in fabrication and installation.



Example of Janisol C4 EI60

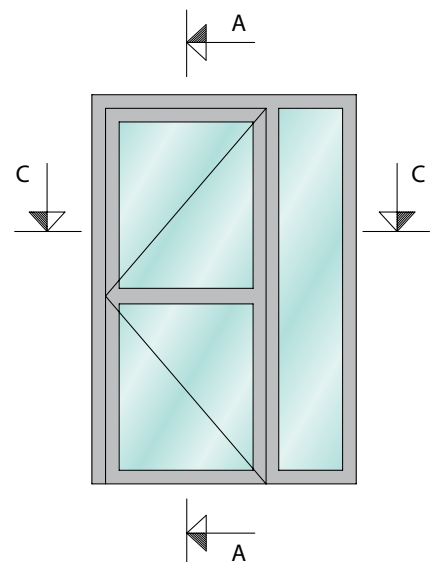
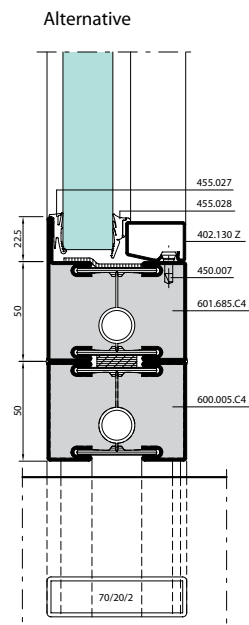
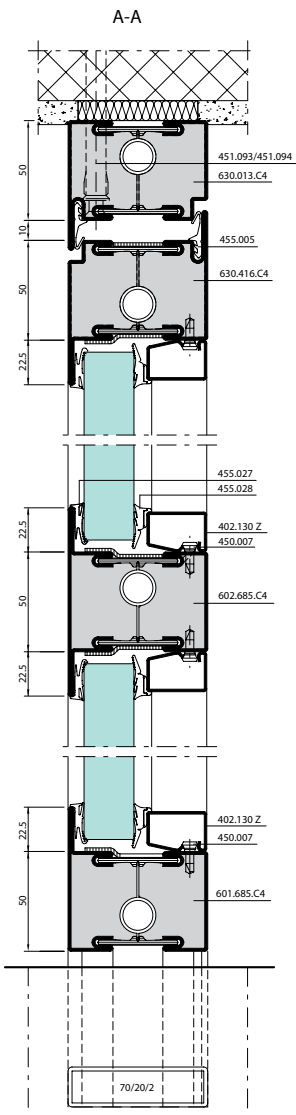
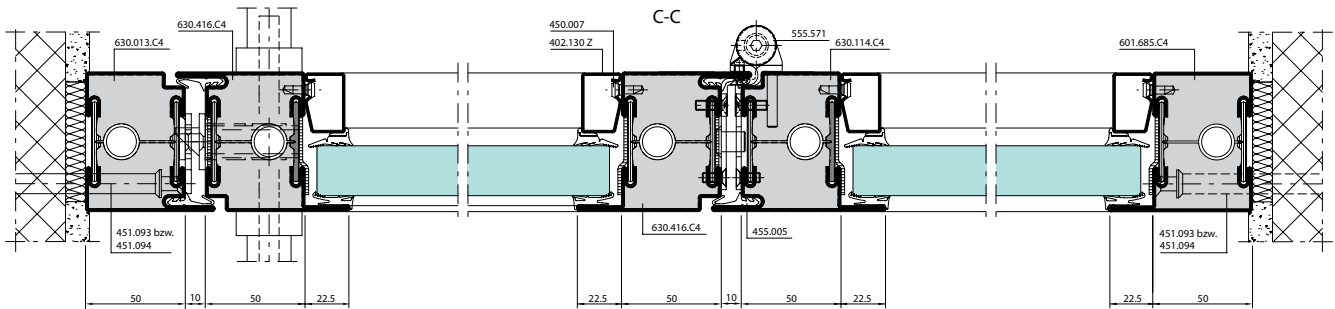

Example of Janisol C4 EI90

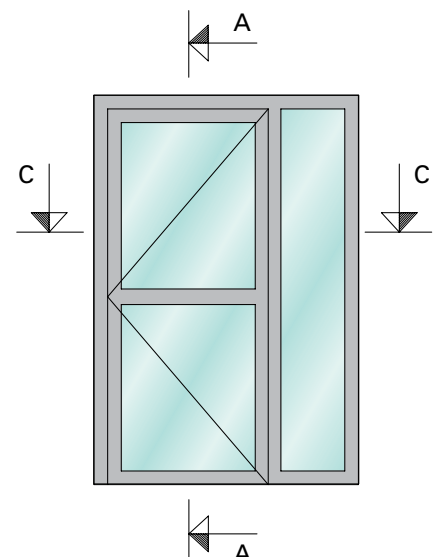
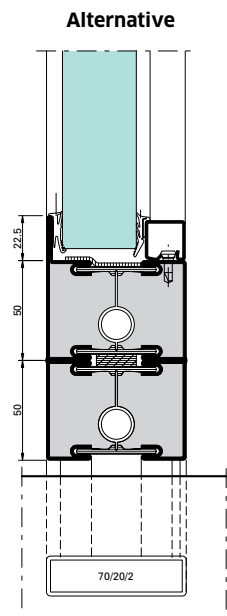
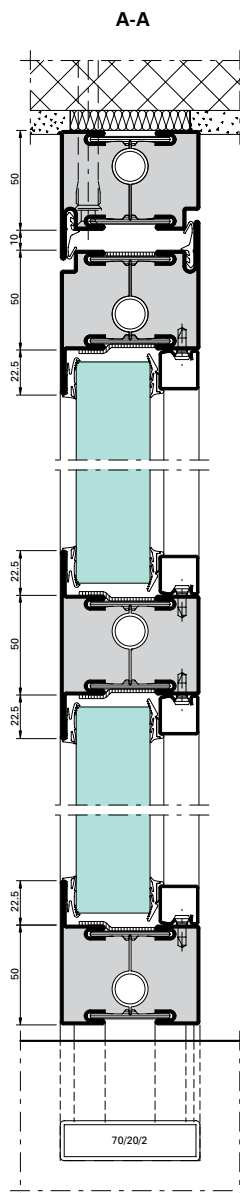
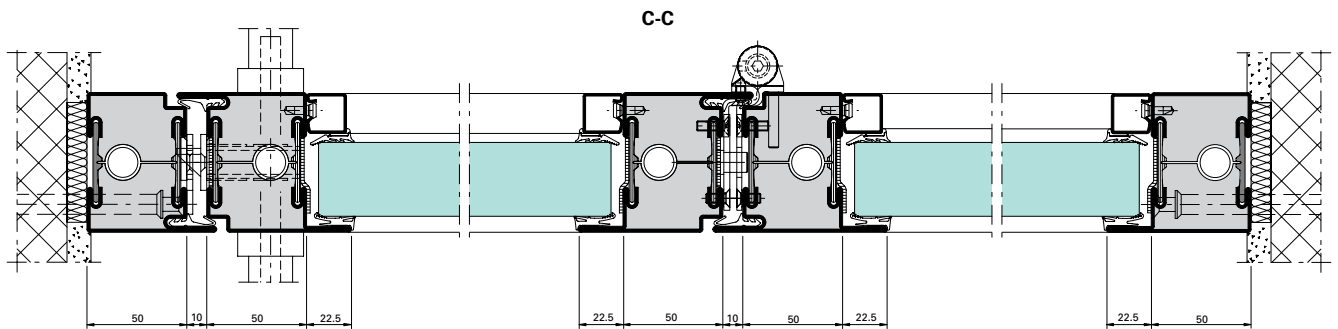

Profile range

Janisol C4 EI60 / EI90

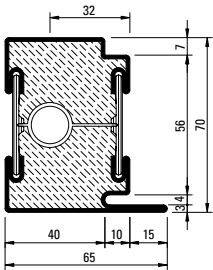

630.013.C4
630.013.C4 Z

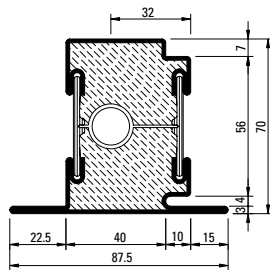

630.114.C4
630.114.C4 Z

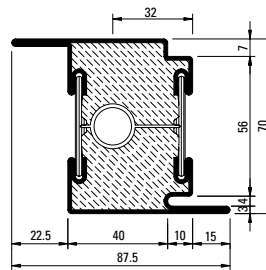

630.416.C4
630.416.C4 Z

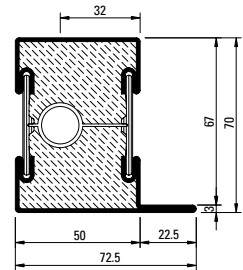

601.685.C4
601.685.C4 Z

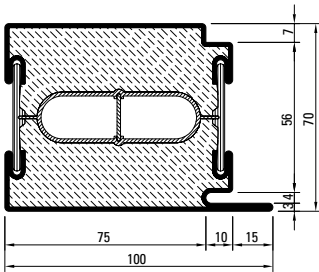

630.016.C4
630.016.C4 Z

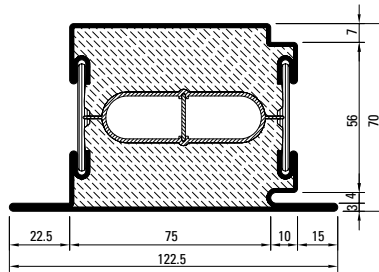

630.115.C4
630.115.C4 Z

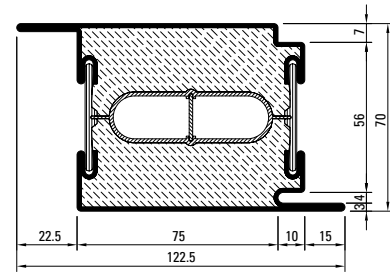

630.417.C4
630.417.C4 Z

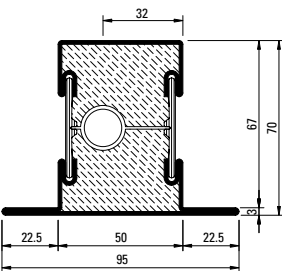

602.685.C4
602.685.C4 Z

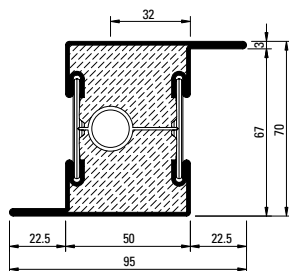

603.685.C4
603.685.C4 Z

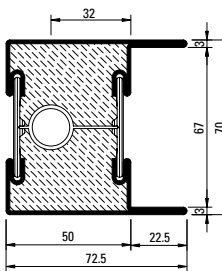

604.685.C4
604.685.C4 Z

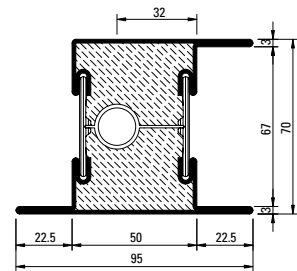

605.685.C4
605.685.C4 Z

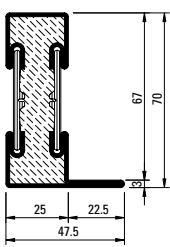

601.635.C4
601.635.C4 Z

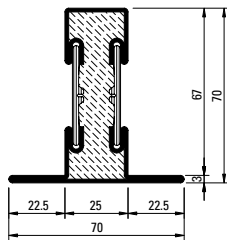

602.635.C4
602.635.C4 Z

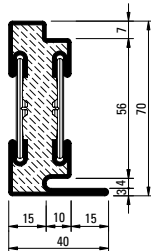

630.010.C4
630.010.C4 Z

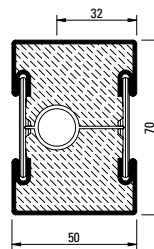

600.005.C4
600.005.C4 Z

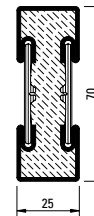

600.006.C4
600.006.C4 Z

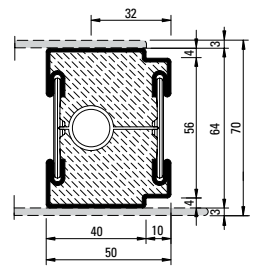

600.010.C4 Z

Z = made from hot-dip galvanised strip



Glazing beads

Steel and aluminium

Steel glazing beads made of hot-dip galvanised strip (length 6 m)

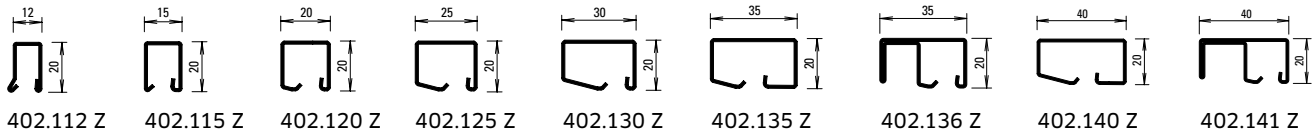

Aluminium glazing beads (length 6 m)*

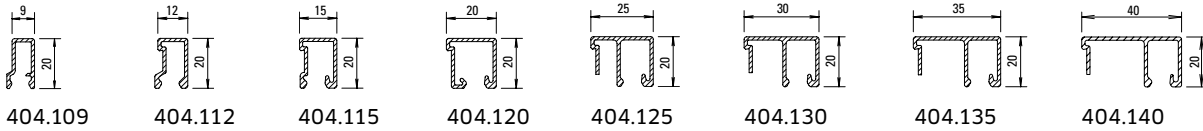

Angle contour steel glazing beads (length approx. 6 m)

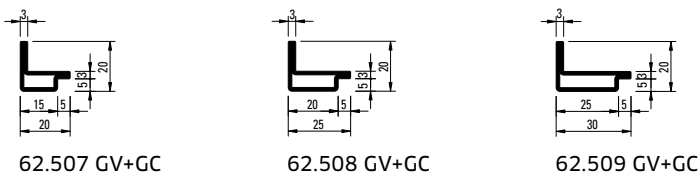

Aluminium glazing beads (length 6 m)*

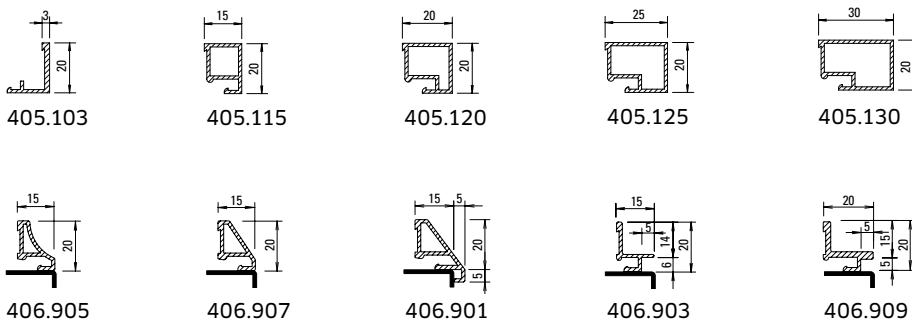

* Only permitted for smoke doors conforming to DIN 18095

System versatility: for every application

Systems	Windows	Doors	Façades	Fixed glazings	Partition walls	Conservatories	Fire protection	Thermal insulation	Safety	System specifications
Janisol/Janisol Primo Basic depth of doors 60 mm Basic depth of windows 60/64 mm	◆	◆		◆	◆	◆		◆	◆	Doors and windows CE tested, anti-finger-trap door, folding wall, burglar resistance RC3 and bullet resistance, steel and stainless steel
Janisol HI Basic depth of doors 80 mm Basic depth of windows 90 mm	◆	◆		◆	◆	◆		◆	◆	Doors and windows CE tested, Minergie tested, highly insulated, windows RC3
Janisol Arte Basic depth 60 mm	◆			◆	◆	◆		◆		Windows CE tested, inward and outward opening windows, very slim face widths
Janisol 2 Basic depth 60 mm/70 mm		◆		◆	◆		◆	◆	◆	Doors and fixed glazings, fire resistant tested EI30, smoke protection, burglar resistance, steel and stainless steel
Janisol C4 Basic depth 70 mm		◆		◆	◆		◆	◆		Doors and fixed glazings, fire resistant tested EI60 and EI90, smoke protection
VISS TV Face width 50/60 mm			◆	◆	◆			◆	◆	Mullion-transom construction for vertical glazings, dry glazing, CE tested, burglar resistance RC4 and bullet resistance
VISS TVS Face width 50/60 mm			◆	◆	◆			◆	◆	Mullion-transom construction for vertical and roof glazings, dry glazing, CE tested, burglar resistance RC4 and bullet resistance
VISS Fire Face width 50 mm			◆	◆			◆			Mullion-transom construction for vertical and roof glazings, tested for fire resistance to E90/EI90
VISS SG Face width 50/60 mm			◆	◆	◆			◆		Structural Glazing façade based on the tried-and-tested VISS system
VISS Basic / VISS I _x tra			◆	◆				◆	◆	Construction for steel and stainless steel façades for mounting on any support
Jansen-Economy 50 Basic depth of doors 50 mm Basic depth of windows 50/58,5 mm	◆	◆		◆	◆		◆		◆	Doors and windows CE tested, anti-finger-trap door, fire resistant tested E30, smoke protection, burglar resistance, steel and stainless steel
Jansen-Economy 60 Basic depth 60 mm		◆		◆	◆		◆		◆	Doors CE tested, anti-finger-trap door, fire resistant tested E30, smoke protection, burglar resistance and bullet resistance
Standard profiles Basic depth 40, 50, 60, 80 mm	◆	◆		◆	◆					Steel profile series for double action doors, frame doors and pilaster profiles
Folding and sliding doors Basic depth 50, 60, 80 mm										Steel profiles for folding and sliding doors, automatic or manual folding, CE tested

Jansen AG

Steel Systems
Industriestrasse 34
9463 Oberriet
Schweiz
jansen.com

JANSEN
Configure to Inspire