

Janisol Faltwand

Wärmege­dämmte Faltwand aus Stahl

Porte repliable Janisol

Porte repliable en acier à rupture de pont thermique

Janisol folding wall

Thermally insulated folding wall in steel

2	Systembeschreibung Description du système System description
4	Leistungseigenschaften Caractéristiques de performance Performance characteristics
5	Merkmale Caractéristiques Features
6	Typenübersicht Sommaire des types Summary of types
7	Profile Profilés Profiles
8	Prinzip-Schnittpunkte Principe de coupe de détails Principle section details
7	Schnittpunkte Coupe de détails Section details

Systembeschreibung

Description du système

System description

Faltwand aus Stahl thermisch getrennt.

Die Janisol Faltwand kann sowohl als Raumteiler als auch für Aussenanlagen genutzt werden. Flexibel einsetzbar – wahlweise nach innen oder aussen öffnend – bietet das Janisol Faltwand-system verschiedene Gestaltungs- und Konstruktionsvarianten. Ein abgestimmtes Beschlüge- und Zubehörsortiment sichert die einwandfreie Funktion und leichtgängige, geräuscharme Bedienung. Für den Schwellenbereich stehen unterschiedliche Ausführungen zur Verfügung. Je nach Faltwandgrösse und Beanspruchung sind Profile mit 25 oder 50 mm Körperbreite einsetzbar. Die Tragfähigkeit der oberen Laufwerke beträgt bis zu 200 kg, was Flügelgewichte bis zu 100 kg erlaubt.

Porte repliable en acier avec séparation thermique.

La porte repliable Janisol peut être utilisée comme séparation ou pour des installations extérieures. Emploi flexible, ouvrant vers l'intérieur ou l'extérieur, le système de porte repliable Janisol offre diverses variantes d'aménagement et de construction. Un assortiment de ferrures et d'accessoires assortis assure une parfaite fonction et une commande aisée et silencieuse. Différents modèles sont disponibles pour le seuil. Suivant la dimension de la porte repliable et la sollicitation, des profilés de 25 ou 50 mm de largeur sont désormais utilisables.

La force portante des mécanismes de roulement supérieurs atteint jusqu'à 200 kg, ce qui permet des poids de vantail jusqu'à 100 kg.

Steel folding wall – thermally broken.

The Janisol folding wall can be used as a room divider and in outside areas. Flexible in use, and either inward or outward-opening, the Janisol folding wall system offers the most diverse design and construction options.





A compatible range of fittings and accessories ensures proper, smooth and quiet operation. A range of designs is available for the threshold. Depending on the size of the folding wall and loading, profiles with a face width of 25 mm or 50 mm can be used.

The load-bearing capacity of the top running gear is up to 200 kg, which permits leaf weights of up to 100 kg.



Leistungseigenschaften
 Caractéristiques de performance
 Performance characteristics

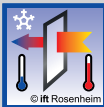

Prüfungen Essais Tests	Norm	Werte Valeurs Values	
Schlagregendichtheit Etanchéité à la pluie battante Watertightness	EN 12208	bis Klasse 8A jusqu'à Classe 8A up to Class 8A	
Widerstand bei Windlast Résistance à la pression du vent Resistance to wind load	EN 12210	bis Klasse C3 jusqu'à Classe C3 up to Class C3	
Luftdurchlässigkeit Perméabilité à l'air Air permeability	EN 12207	bis Klasse 4 jusqu'à Classe 4 up to Class 4	
Wärmedurchgangskoeffizient Transmission thermique Thermal production	EN ISO 10077-1	ab $U_f > 2,5 \text{ W/m}^2\text{K}$ dès $U_f > 2,5 \text{ W/m}^2\text{K}$ from $U_f > 2,5 \text{ W/m}^2\text{K}$	
Schallschutz Isolation phonique Sound insulation	EN ISO 140-3	bis R_w 45 dB jusqu'à R_w 45 dB to R_w 45 dB	
Bedienungskräfte Forces de manœuvre Operating forces	EN 13115	Klasse 1 Classe 1 Class 1	

Typenübersicht

Sommaire des types

Summary of types

2+0

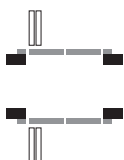

3+0

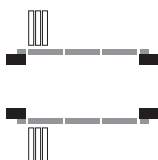
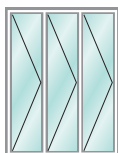

2+1

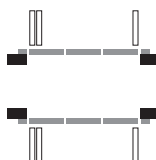
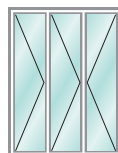

3+1

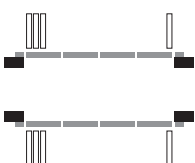

2+2

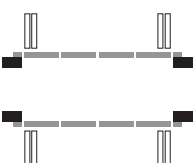

4+0

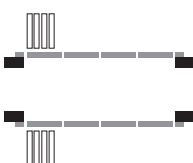
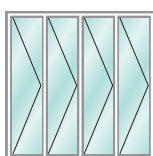

5+0

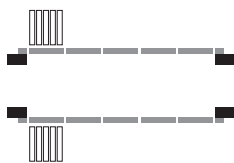
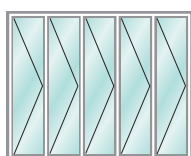

4+1

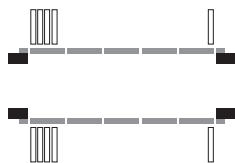
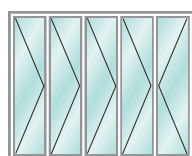

3+2

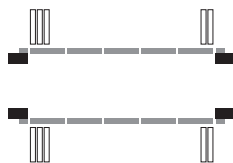
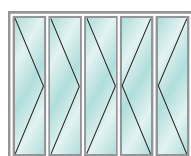

5+1

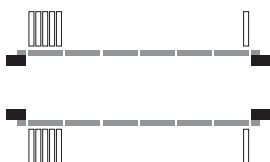
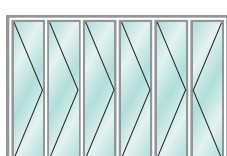

3+3

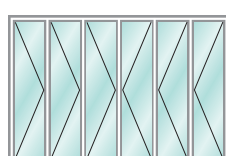

6+0

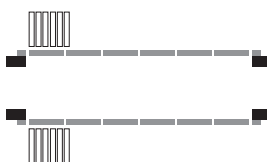
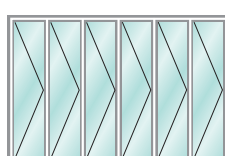

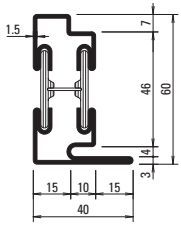

630.010
 630.010 Z

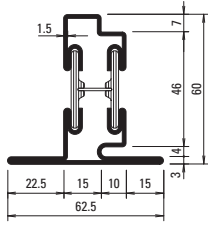

630.110
 630.110 Z

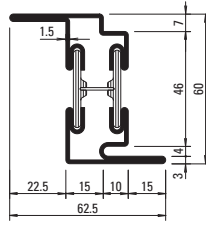

630.411
 630.411 Z

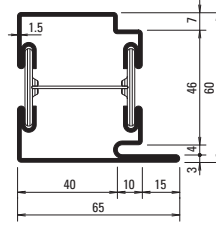

630.013
 630.013 Z

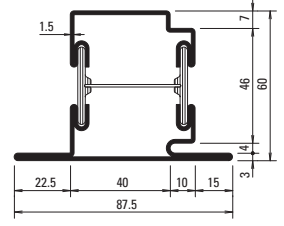

630.114
 630.114 Z

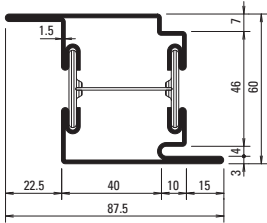

630.416
 630.416 Z

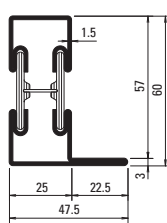

601.635
 601.635 Z

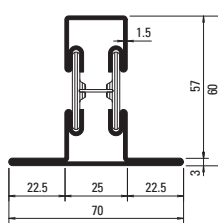

602.635
 602.635 Z

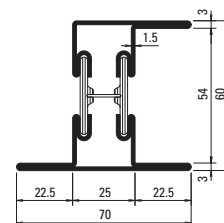

605.635
 605.635 Z

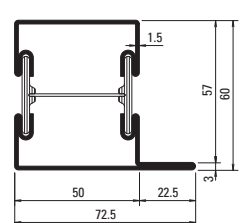

601.685
 601.685 Z

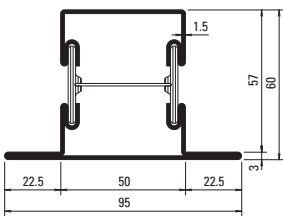

602.685
 602.685 Z

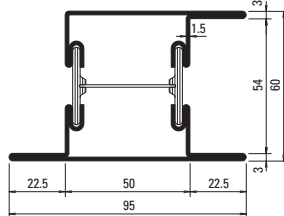

605.685
 605.685 Z

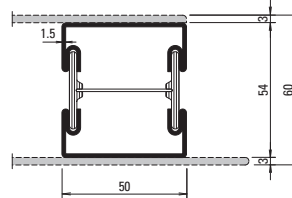

600.007 Z

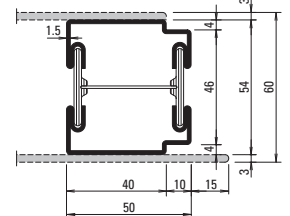

600.010 Z

Oberfläche

Artikel-Nr.

ohne Zusatz = blank

mit Z =

aus feuerverzinktem Bandstahl

Surface

No. d'article

sans supplément = brut

avec Z =

en bandes d'acier zinguées au feu

Surface

Part no.

without addition = bright

with Z =

made from hot-dip galvanised strip

Prinzip-Schnittpunkte
Principe de coupe de détails
Principle section details

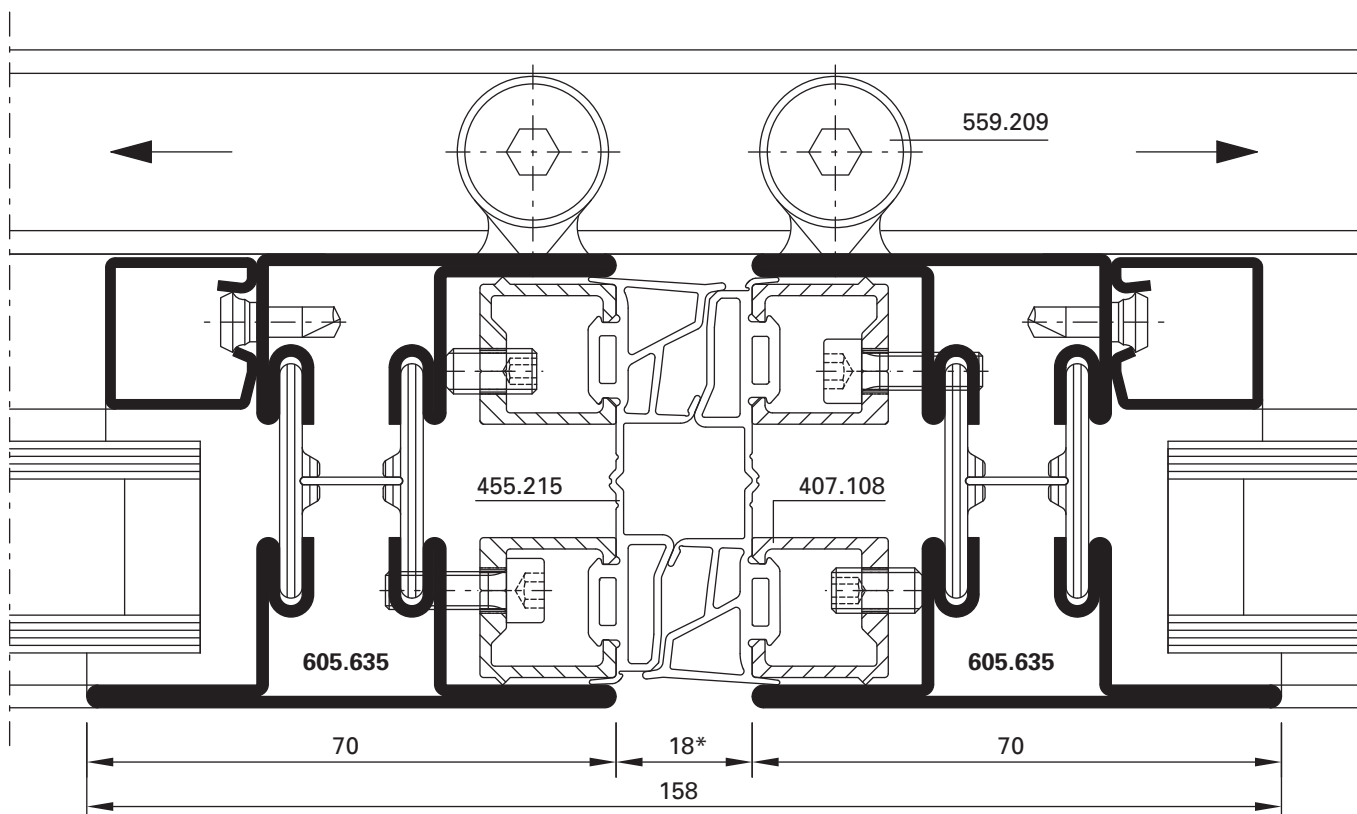
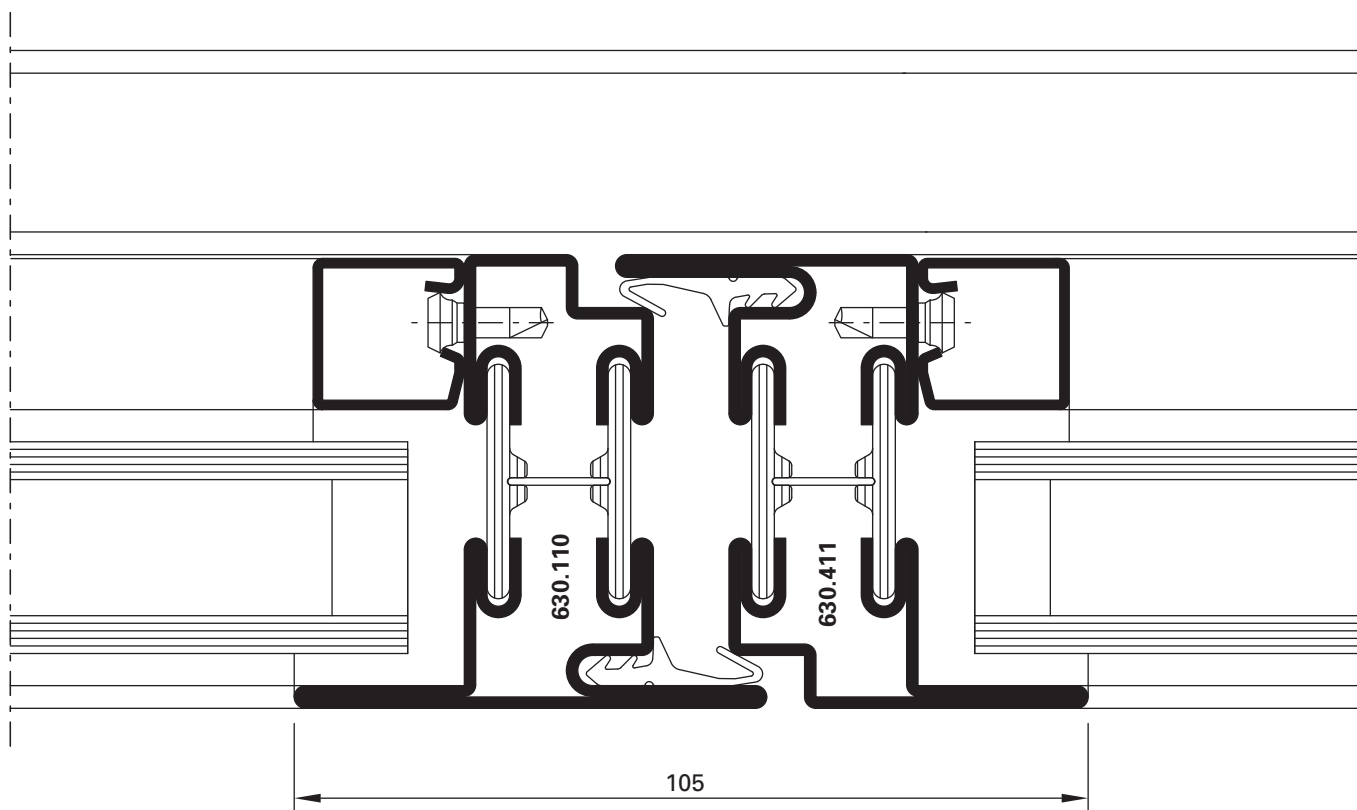

Schnittpunkte Coupe de détails Section details

Schnittpunkte im Massstab 1:1
Coupe de détails à l'échelle 1:1
Section details on scale 1:1

Janisol-Faltwand
Porte repliable Janisol
Janisol folding wall

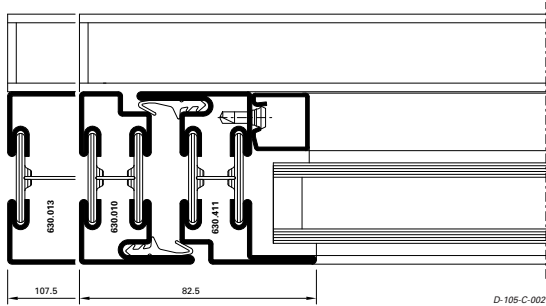
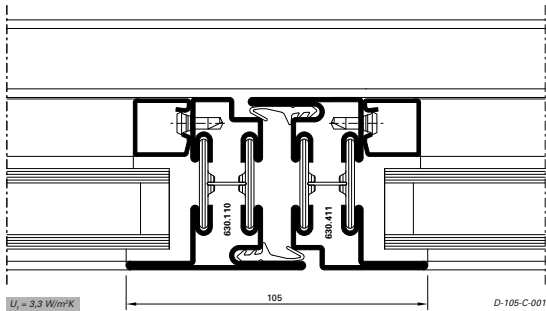

A-71-14 01/2014 **JANSEN**

Schnittpunkte im Massstab 1:1
Coupe de détails à l'échelle 1:1
Section details on scale 1:1

Janisol-Faltwand
Porte repliable Janisol
Janisol folding wall

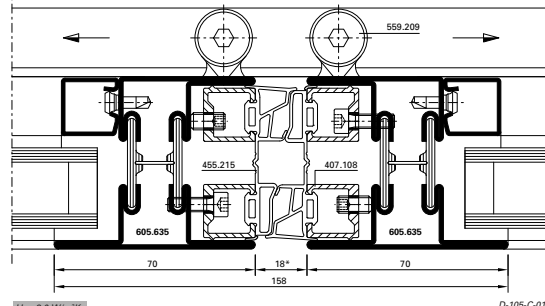
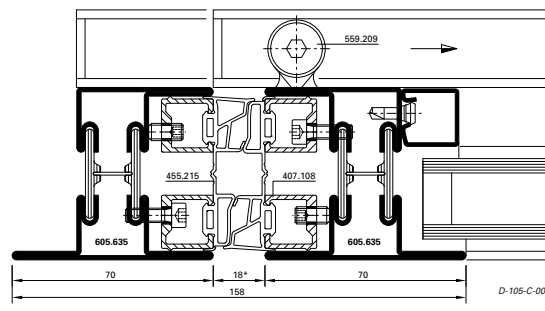

* Verstellbarkeit: ± 4 mm * Réglage possible sur ± 4 mm * Range of adjustment ± 4 mm

A-71-16 01/2014 **JANSEN**

Schnittpunkte im Massstab 1:1
Coupe de détails à l'échelle 1:1
Section details on scale 1:1

Janisol-Faltwand
Porte repliable Janisol
Janisol folding wall

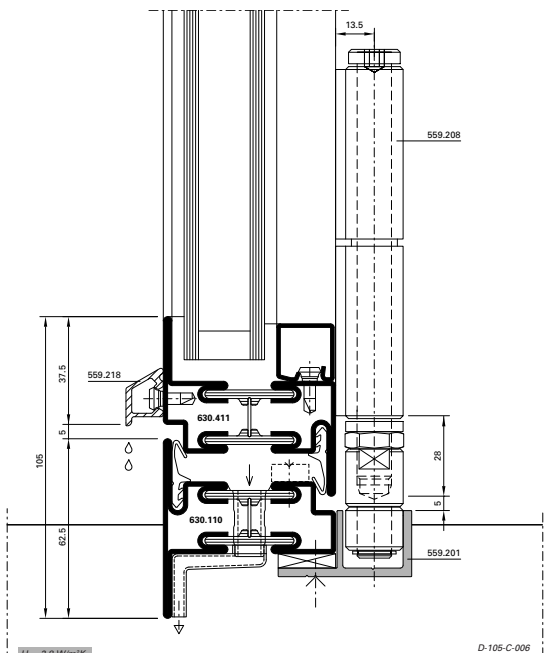

A-71-18 01/2014 **JANSEN**

Schnittpunkte im Massstab 1:1
Coupe de détails à l'échelle 1:1
Section details on scale 1:1

Janisol-Faltwand
Porte repliable Janisol
Janisol folding wall

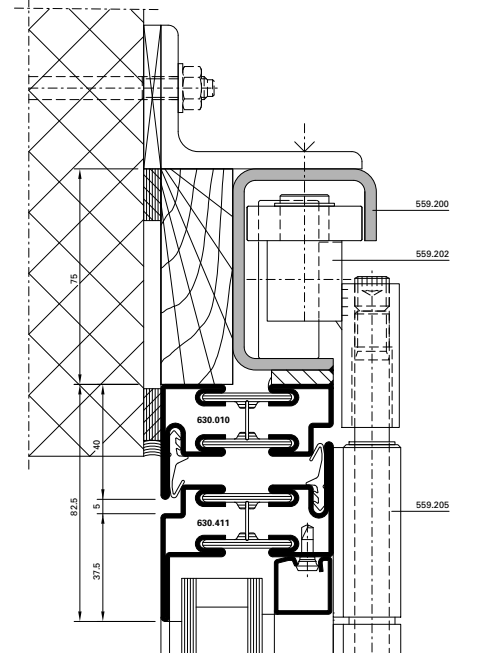

JANSEN 01/2014 A-71-17

Anwendungsbeispiele

Exemples d'application

Examples of applications

Schnittpunkte nach innen öffnend (D-105-S-001)
 Coupe de détails ouvrant vers l'intérieur (D-105-S-001)
 Section details opening inwards (D-105-S-001)

Janisol-Faltwand
 Porte repliable Janisol
 Janisol folding wall

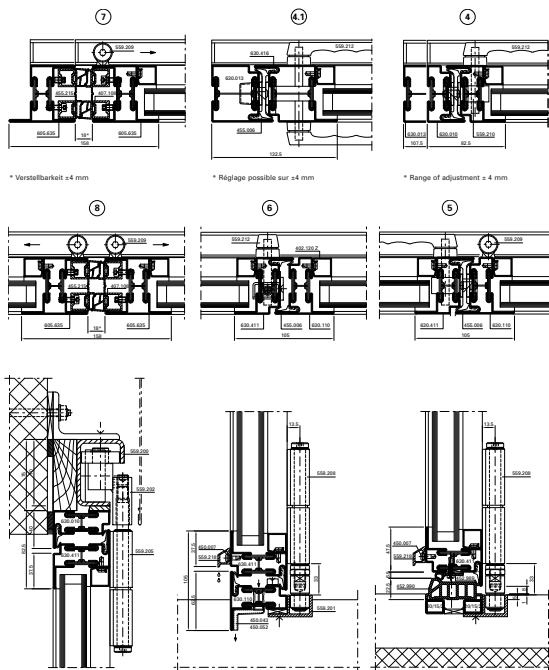

* Verstellbarkeit ± 4 mm

* Réglage possible sur ± 4 mm

* Range of adjustment ± 4 mm

A-71-22 01/2014

JANSEN

Schnittpunkte nach innen öffnend (D-105-S-001)
 Coupe de détails ouvrant vers l'intérieur (D-105-S-001)
 Section details opening inwards (D-105-S-001)

Janisol-Faltwand
 Porte repliable Janisol
 Janisol folding wall

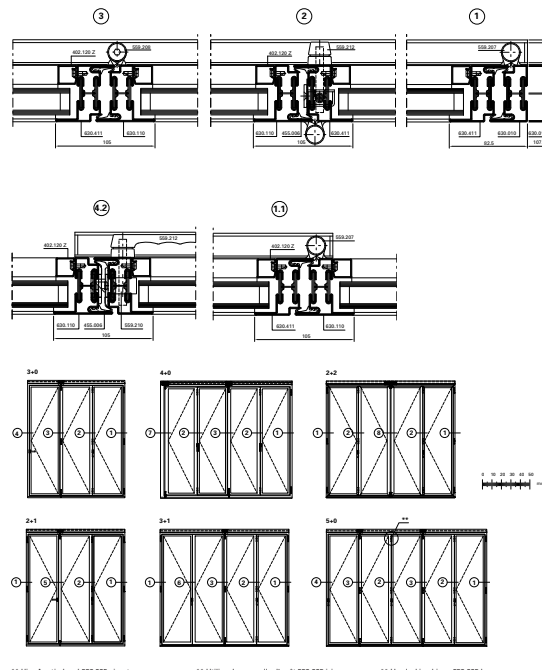

** Hier Anreterband 559.225 einsetzen

** Utiliser la paumelle d'arrêt 559.225 ici

** Use locking hinge 559.225 here

JANSEN

01/2014 A-71-23

Schnittpunkte nach innen öffnend (D-105-S-002)
 Coupe de détails ouvrant vers l'intérieur (D-105-S-002)
 Section details opening inwards (D-105-S-002)

Janisol-Faltwand
 Porte repliable Janisol
 Janisol folding wall

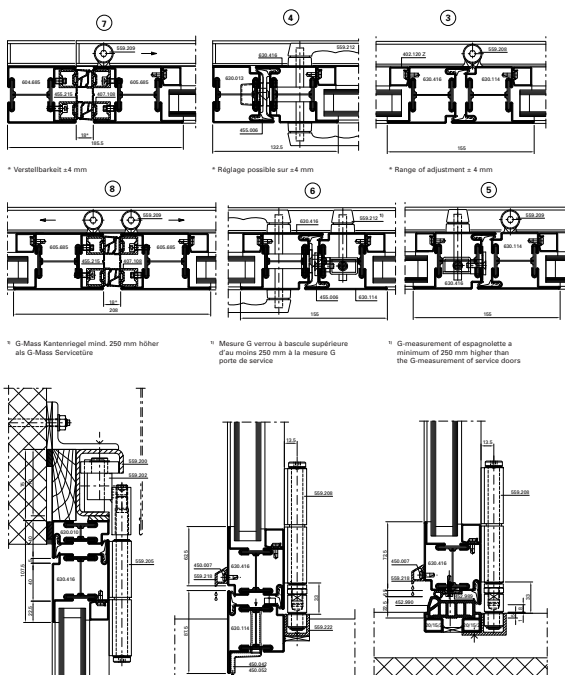

* Verstellbarkeit ± 4 mm

* Réglage possible sur ± 4 mm

* Range of adjustment ± 4 mm

* G-Mass Kantenvirgel mind. 250 mm höher als G-Mass Serviceüre

* Mesure G verrou à bascule supérieure d'au moins 250 mm à la mesure G porte de service

* G-measurement of espagnolette a minimum of 250 mm higher than the G-measurement of service door

A-71-24 01/2014

JANSEN

Schnittpunkte nach innen öffnend (D-105-S-002)
 Coupe de détails ouvrant vers l'intérieur (D-105-S-002)
 Section details opening inwards (D-105-S-002)

Janisol-Faltwand
 Porte repliable Janisol
 Janisol folding wall

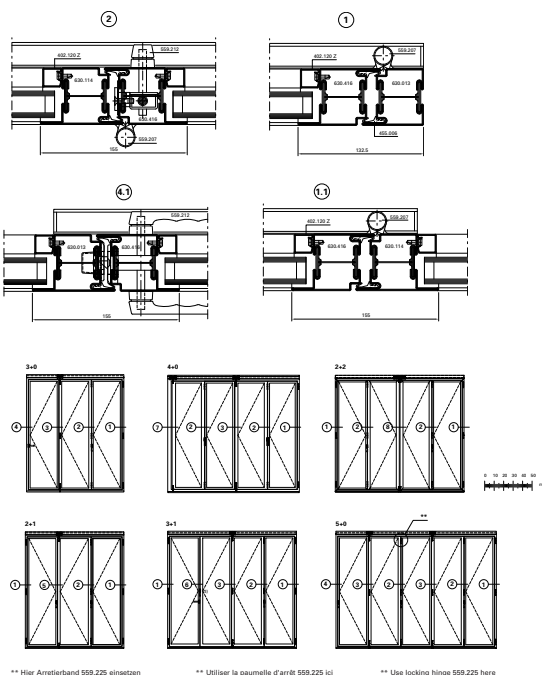

** Hier Anreterband 559.225 einsetzen

** Utiliser la paumelle d'arrêt 559.225 ici

** Use locking hinge 559.225 here

JANSEN

01/2014 A-71-25

Schnittpunkte nach aussen öffnend (D-105-S-003)
 Coupe de détails ouvrant vers l'extérieur (D-105-S-003)
 Section details opening outwards (D-105-S-003)

Janisol-Faltwand
 Porte repliable Janisol
 Janisol folding wall

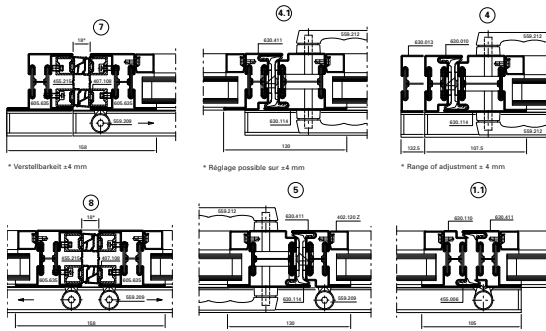

* Verstellbarkeit ±4 mm * Réglage possible sur ±4 mm * Range of adjustment ± 4 mm

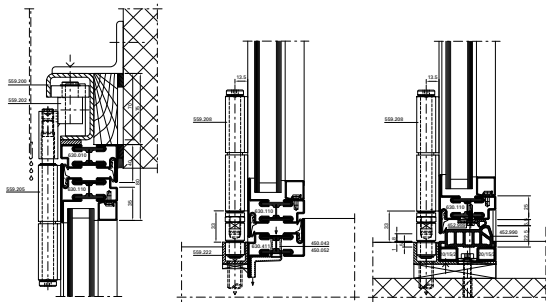

A-71-25

01/2014

JANSEN

Schnittpunkte nach aussen öffnend (D-105-S-003)
 Coupe de détails ouvrant vers l'extérieur (D-105-S-003)
 Section details opening outwards (D-105-S-003)

Janisol-Faltwand
 Porte repliable Janisol
 Janisol folding wall

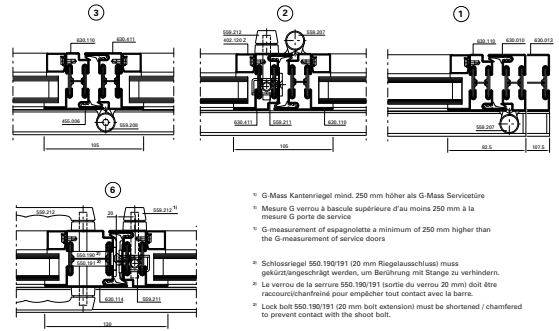

- 1 G-Mass Kantenriegel mind. 250 mm höher als G-Mass Servicetüre
- 2 Mesure G verrou à bascule supérieure d'au moins 250 mm à la mesure G porte de service
- 3 G-messurament of espagnolette a minimum of 250 mm higher than the G-messurament of service doors
- 4 Schlosriegel 559.190/191 (20 mm Riegelabschluss) muss gekürzungsbedingt werden, um Berührung mit Stange zu verhindern.
- 5 Le verrou de la serrure 559.190/191 (sortie du verrou 20 mm) doit être raccourci/charnière pour empêcher tout contact avec la barre.
- 6 Lock bolt 559.190/191 (20 mm bolt extension) must be shortened / chamfered to prevent contact with the shoot bolt.

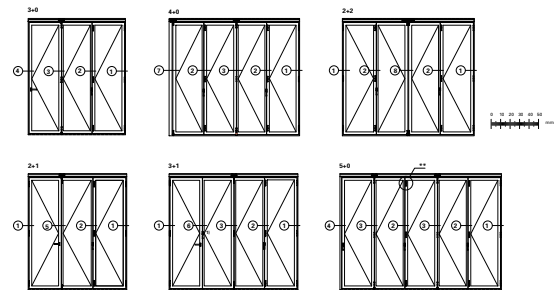

** Hier Anreiterband 559.225 einsetzen

** Utiliser la paumelle d'arrêt 559.225 ici

** Use locking hinge 559.225 here

JANSEN

01/2014

A-71-27

Schnittpunkte nach aussen öffnend (D-105-S-004)
 Coupe de détails ouvrant vers l'extérieur (D-105-S-004)
 Section details opening outwards (D-105-S-004)

Janisol-Faltwand
 Porte repliable Janisol
 Janisol folding wall

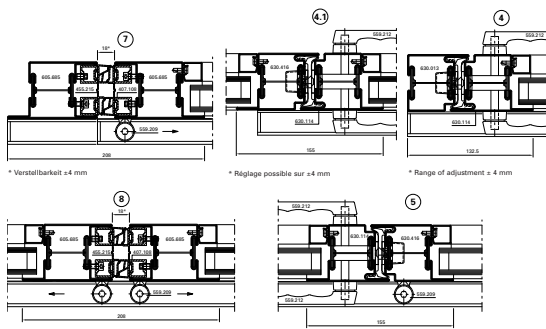

* Verstellbarkeit ±4 mm * Réglage possible sur ±4 mm * Range of adjustment ± 4 mm

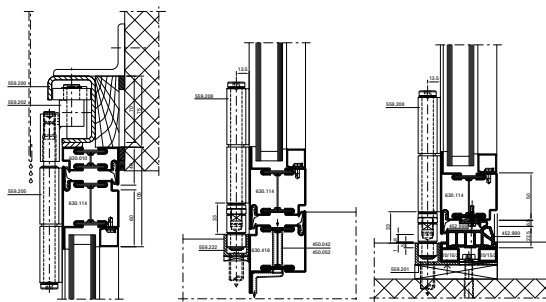

A-71-28

01/2014

JANSEN

Schnittpunkte nach aussen öffnend (D-105-S-004)
 Coupe de détails ouvrant vers l'extérieur (D-105-S-004)
 Section details opening outwards (D-105-S-004)

Janisol-Faltwand
 Porte repliable Janisol
 Janisol folding wall

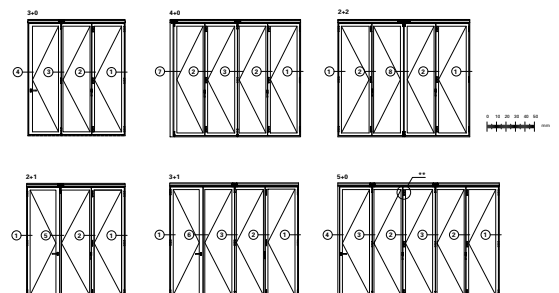
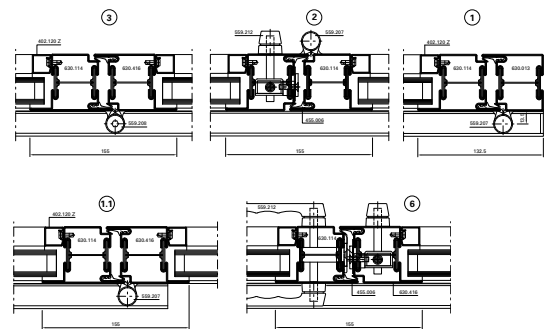

** Hier Anreiterband 559.225 einsetzen

** Utiliser la paumelle d'arrêt 559.225 ici

** Use locking hinge 559.225 here

JANSEN

01/2014

A-71-29

U_f Werte nach EN 10077-2
 Valeurs U_f selon EN 10077-2
 U_f values according to 10077-2

Füllelementstärken
 Elements de remplissages
 Infill elements

> 24 mm

Füllelementstärken
 Elements de remplissages
 Infill elements

> 24 mm

Füllelementstärken
 Elements de remplissages
 Infill elements

> 24 mm

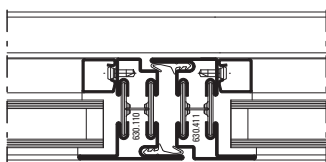

3,3 W/m²K

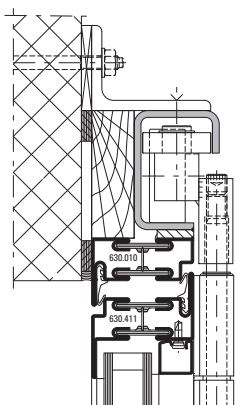

3,4 W/m²K

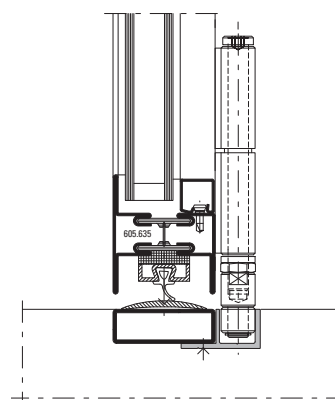

3,7 W/m²K

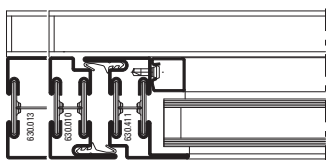

2,8 / 3,4 W/m²K

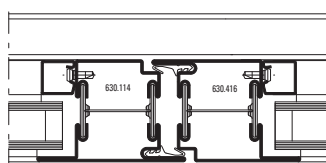

2,5 W/m²K

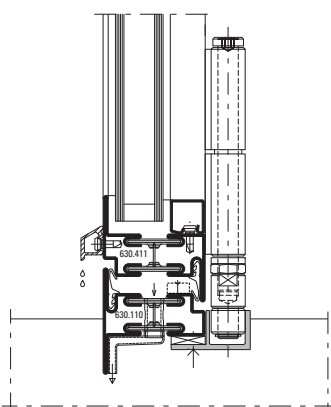

2,8 W/m²K

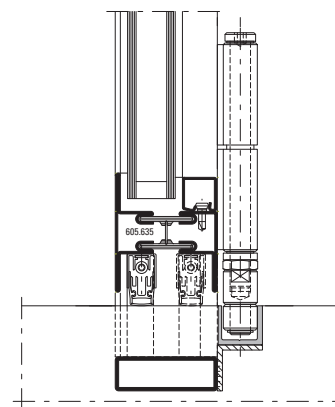

3,6 W/m²K

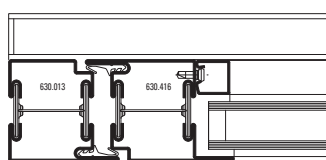

2,5 W/m²K

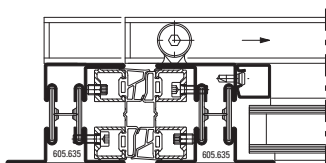

2,9 W/m²K

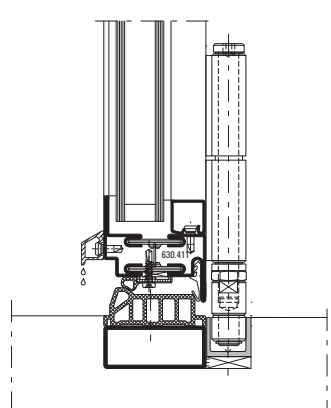

2,9 W/m²K

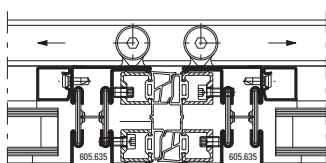

3,0 W/m²K