

# Janisol HI - Fenster und Türen

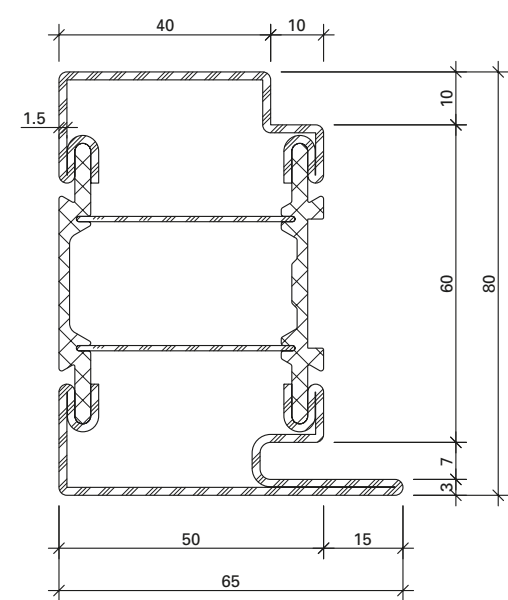

680.013 Z

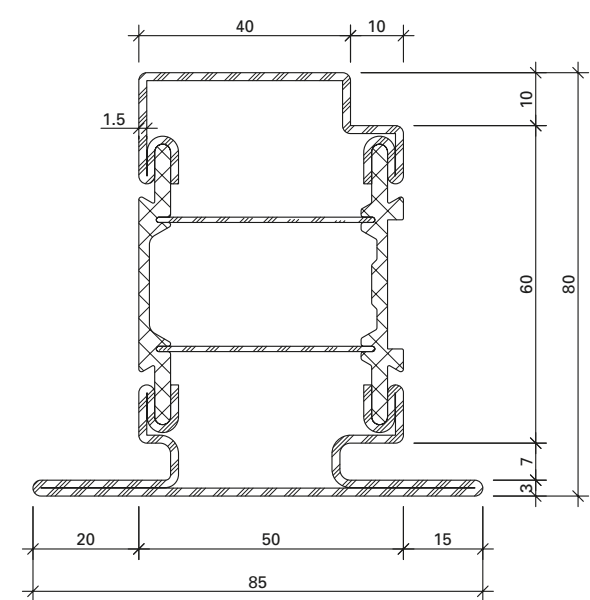

680.114 Z

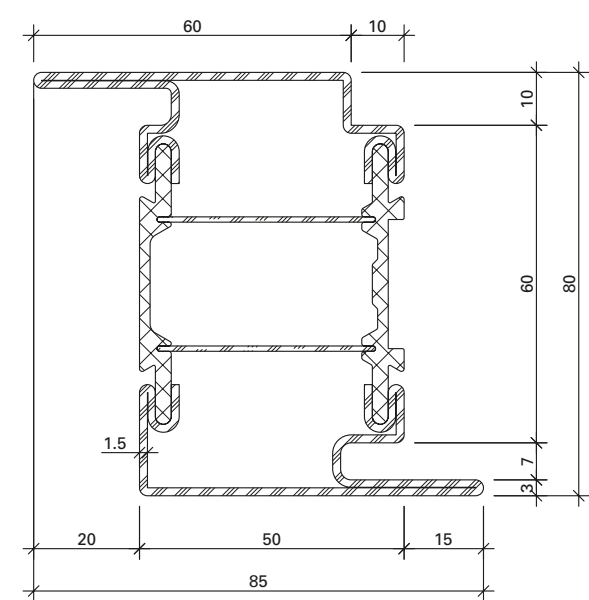

680.416 Z

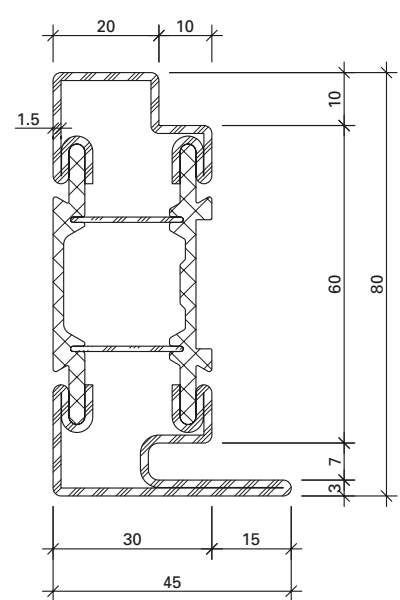

680.010 Z

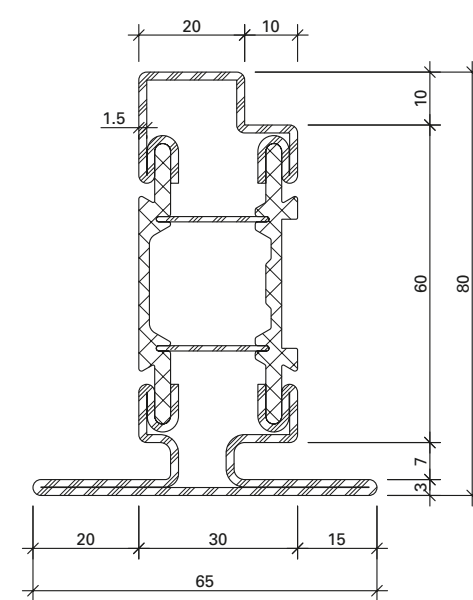

680.110 Z

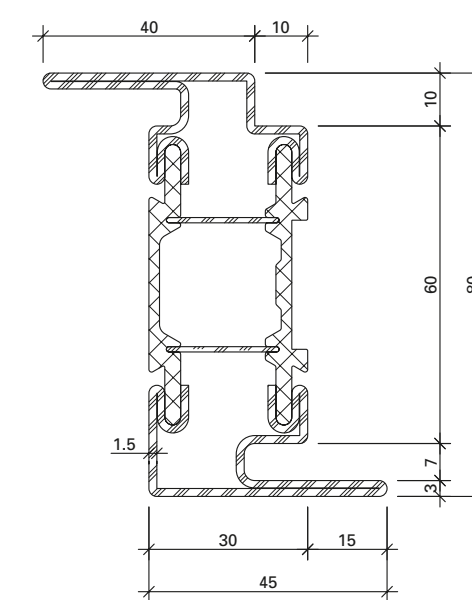

680.411 Z

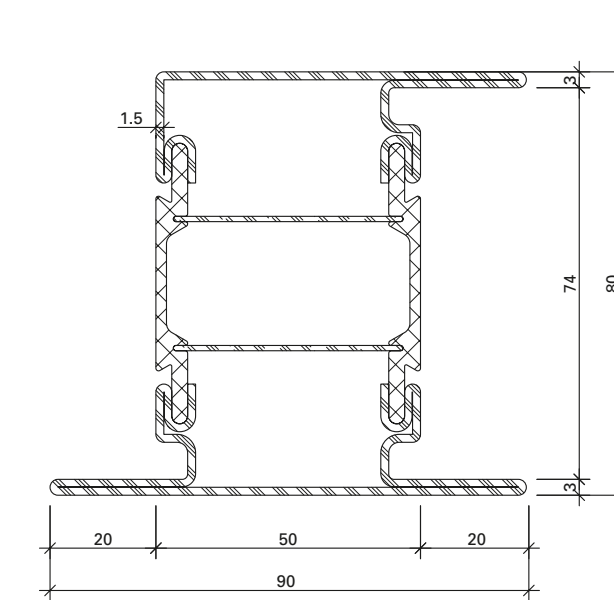

680.650 Z

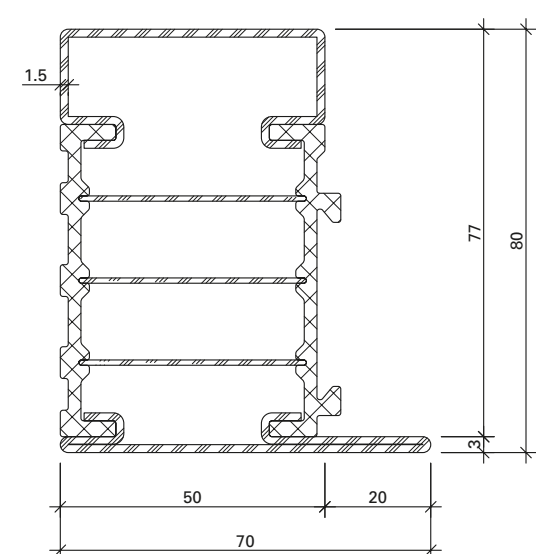

681.650 Z

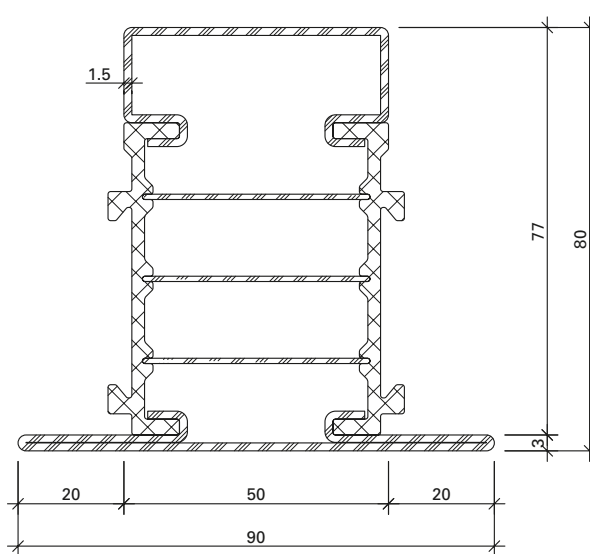

682.650 Z

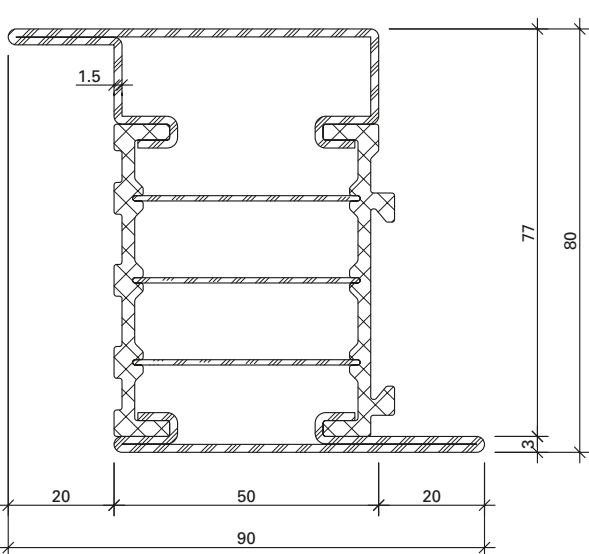

683.650 Z

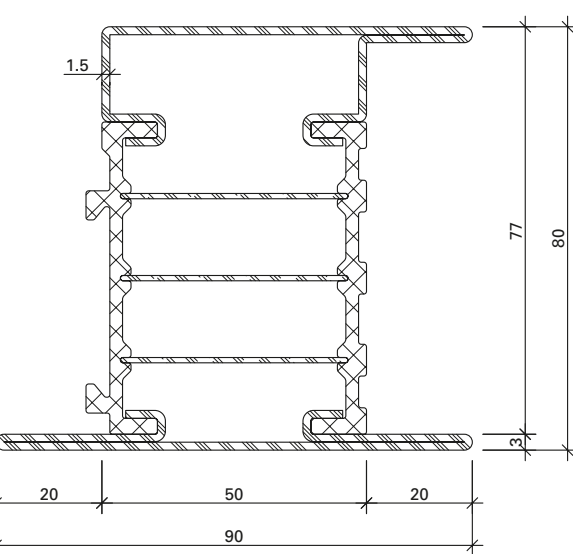

685.650 Z

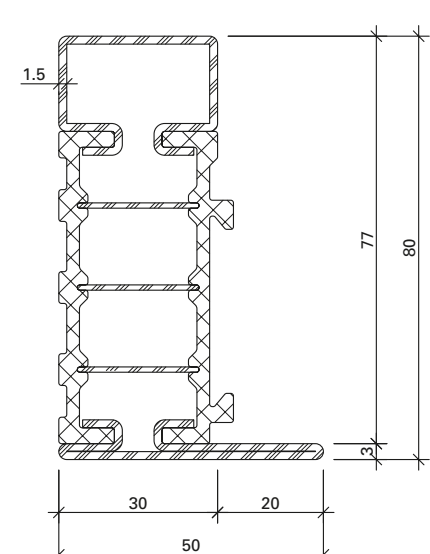

681.630 Z

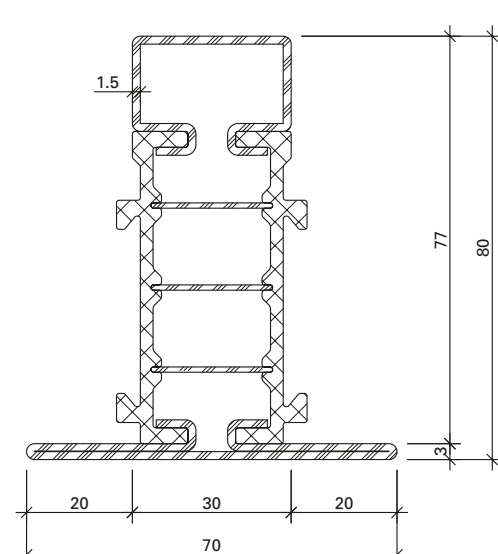

682.630 Z

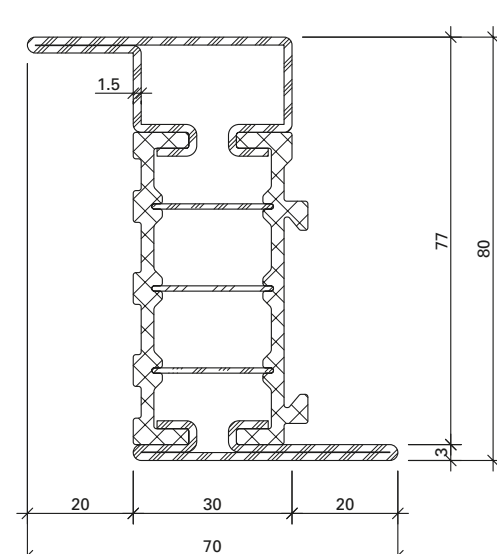

683.630 Z

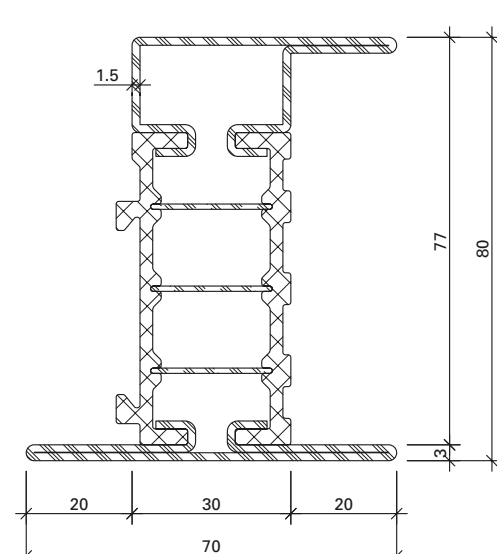

685.630 Z

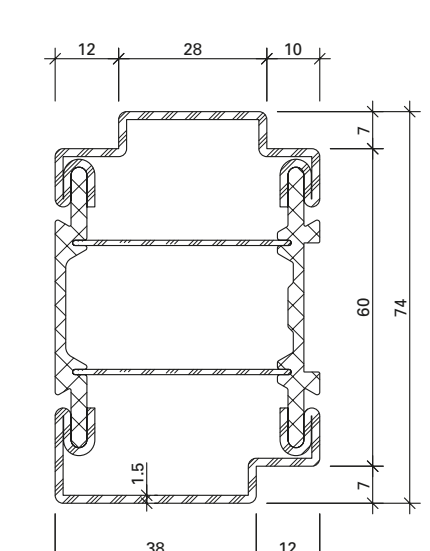

680.051 Z

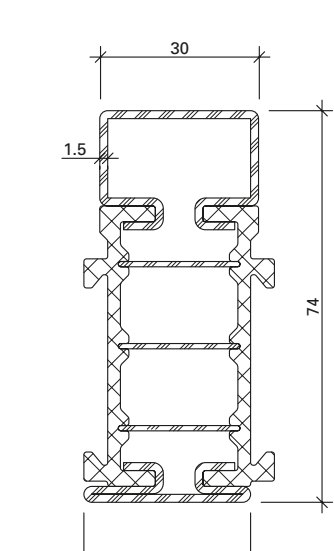

680.060 Z

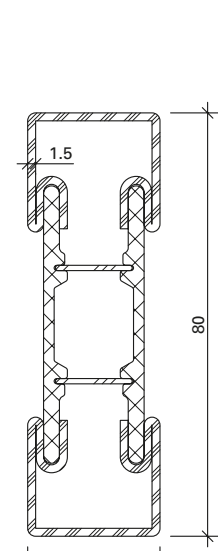

600.012  
600.012 Z

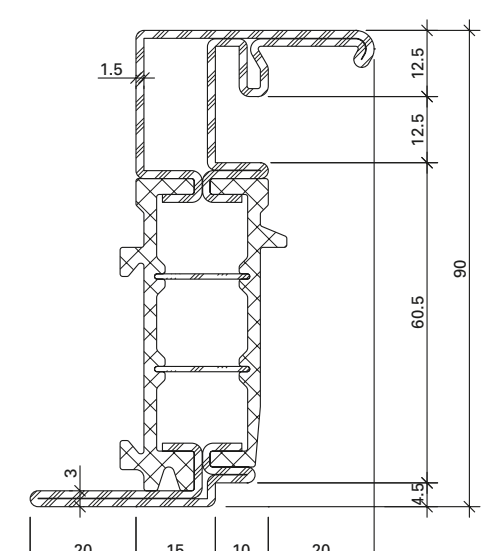

680.900 Z

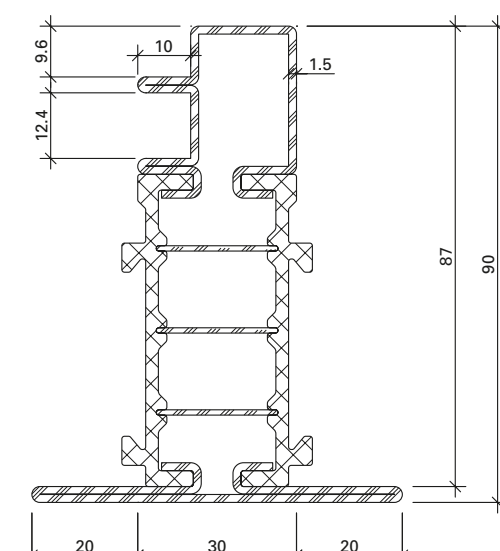

680.901 Z

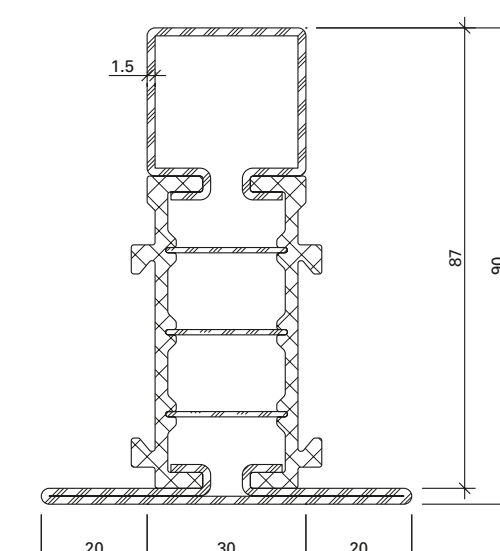

680.902 Z

## Werkstoffe

Artikel-Nr.

ohne Zusatz= blank

mit Z = bandverzinkter Stahl

## Matériaux

No. d'article

sans supplément = brut

avec Z = bande d'acier zinguée

## Materials

Part no.

without addition = bright

with Z = strip galvanised steel

# Janisol Hebeschiebetüren

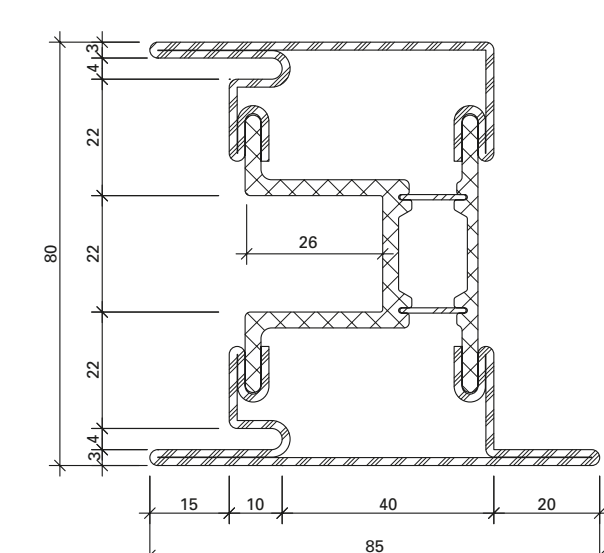

630.920  
630.920 Z

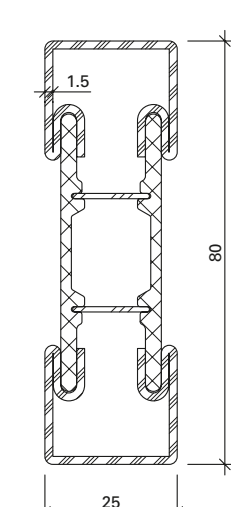

600.012  
600.012 Z

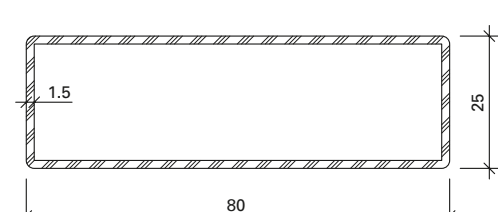

400.056  
400.056 Z

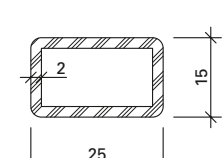

400.057  
400.057 Z